

## BP01

### MC基板 M/C BASE PLATE



材质: HT250/QT500  
热处理: 退火  
用处: 适用于立式MC  
优点: 可根据实际需要, 自行钻孔加工制作专用治具

Material: Cast Iron HT250/QT500  
Heat treated (Normalized)  
Application: Vertical Machining Center.  
Features: Ready to accept a hole pattern for your special jig.

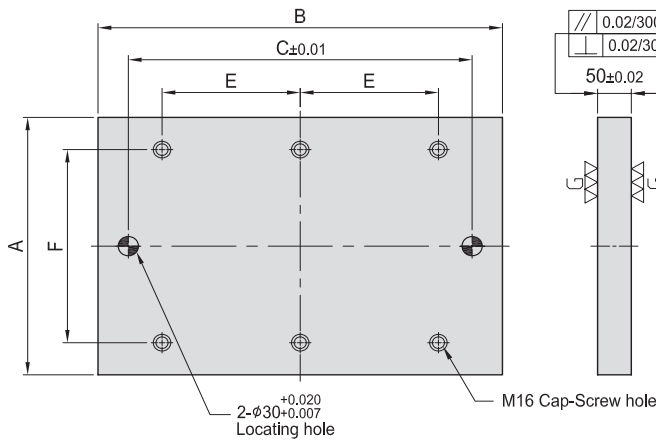

MODEL NO.	A	B	C	E	F	kg
BP01-50400-0600	400	600	-	-	-	88
BP01-50500-0600	500					106
BP01-50600-0600	600					127
BP01-50400-0800	400	800	-	-	-	113
BP01-50450-0900	450	900	-	-	-	142
BP01-50500-1000	500	1000	-	-	-	176
BP01-50600-1200	600	1200	-	-	-	256

\*Special Design Welcome !

## BP02

### MC基板 M/C BASE PLATE



材质: HT250/QT500  
热处理: 退火  
用处: 适用于立式MC  
优点: 以孔定位方式, 利用标准化治具零件, 可以快速组合成一套符合需求的治具。

Material: Cast Iron HT250/QT500  
Heat treated (Normalized)  
Application: Vertical Machining Center.  
Features: Alignment bushing & thread insert at every hole location, easily adapts to standardized jig components.

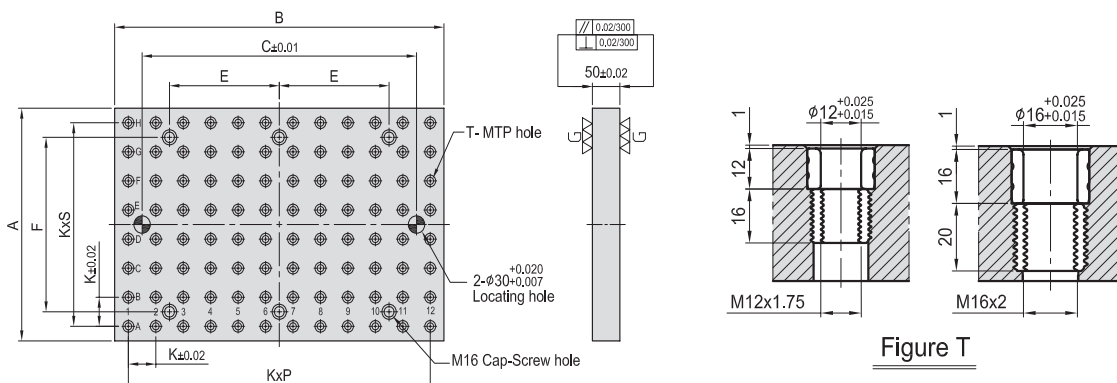

Figure T

MODEL NO.	A	B	C	E	F	T	K	P	S	MTP	kg	
BP02-50400-0600-12	400	600	-	-	-	Ø12	M12	50	11	7	96	90
BP02-50500-0600-12	500									9	120	112
BP02-50600-0600-12	600									11	144	134
BP02-50400-0800-12	400	800	-	-	-	Ø12	M12	50	15	7	128	109
BP02-50450-0900-12	450	900	-	-	-	Ø12	M12	50	17	8	158	138
BP02-50500-1000-12	500	1000	-	-	-	Ø12	M12	50	19	9	200	165
BP02-50600-1200-12	600	1200	-	-	-	Ø12	M12	50	23	11	288	244
MODEL NO.	A	B	C	E	F	T	K	P	S	MTP	kg	
BP02-50400-0600-16	400	600	-	-	-	Ø16	M16	50	11	7	96	89
BP02-50500-0600-16	500									9	120	108
BP02-50600-0600-16	600									11	144	120
BP02-50400-0800-16	400	800	-	-	-	Ø16	M16	50	15	7	128	108
BP02-50450-0900-16	450	900	-	-	-	Ø16	M16	50	17	8	158	134
BP02-50500-1000-16	500	1000	-	-	-	Ø16	M16	50	19	9	200	164
BP02-50600-1200-16	600	1200	-	-	-	Ø16	M16	50	23	11	288	240

\*Special Design Welcome !

# BP03

## MC基板 M/C BASE PLATE



材质: HT250/QT500  
 热处理: 退火  
 用处: 适用于立式MC  
 优点: 以T型槽定位方式, 利用标准化治具零件, 可以快速组合完成一套符合需求的治具。

Material: Cast Iron HT250/QT500  
 Heat treated: Normalized  
 Application: Vertical Machining Center.  
 Features: T-Slots running in 2 directions, easily adapts to standardized jig components.

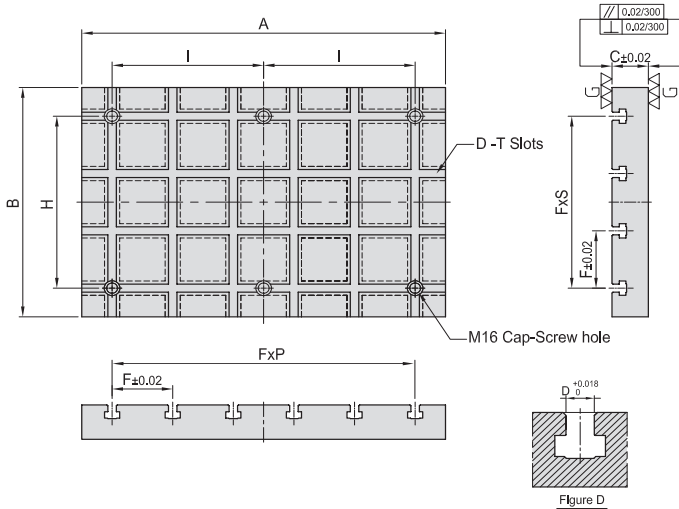

MODEL NO.	A	B	C	D	F	P	S	H	I	kg
BP03-60400-0600-14		400					3			92
BP03-60500-0600-14	600	500	60	14	100	5	4	-	-	115
BP03-60600-0600-14		600					5			130
BP03-60400-0800-14	800	400					7	3	-	117
BP03-60450-0900-14	900	450	60	14	100		8			168
BP03-60500-1000-14	1000	500					9	4	-	198
BP03-60600-1200-14	1200	600	60	14	100		11	5	-	264

MODEL NO.	A	B	C	D	F	P	S	H	I	kg
BP03-75400-0600-18		400					3			118
BP03-75500-0600-18	600	500	75	18	100	5	4	-	-	147
BP03-75600-0600-18		600					5			173
BP03-75400-0800-18	800	400	75	18	100		7	3	-	151
BP03-75450-0900-18	900	450					8			182
BP03-75500-1000-18	1000	500	75	18	100		9	4	-	228
BP03-75600-1200-18	1200	600					11	5	-	329

# BP04

## MC基板 M/C BASE PLATE



材质: HT250/QT500  
 热处理: 退火  
 用处: 适用于卧式MC  
 优点: 可根据实际需求, 自行钻孔加工制作专用治具。

Material: Cast Iron HT250/QT500  
 Heat treated (Normalized)  
 Application: Horizontal Machining Center.  
 Features: Ready to accept a hole pattern for your special jig.

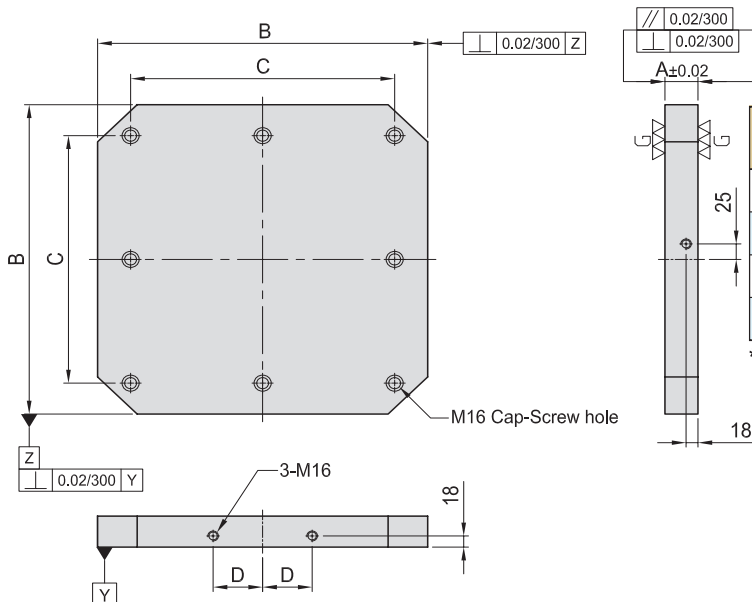

MODEL NO.	A	B	C	D	Mounting holes	kg
BP04-50400-0400	50	400	320	55	4	57
BP04-50500-0500	50	500	400	75	8	88
BP04-50630-0630	50	630	500	100	8	140
BP04-50800-0800	50	800	640	135	8	225

\*Special Design Welcome !



## BP05

### MC基板 M/C BASE PLATE

材质: HT250/QT500  
 热处理: 退火  
 用处: 适用于卧式MC  
 优点: 以孔定位方式, 利用标准化治具零件, 可以快速组合成一套符合需求的治具。

Material: Cast Iron HT250/QT500  
 Heat treated (Normalized)  
 Application: Horizontal Machining Center.  
 Features: Alignment bushing & thread insert at every hole location, easily adapts to standardized jig components.

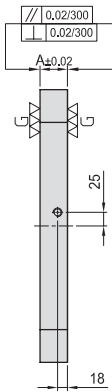
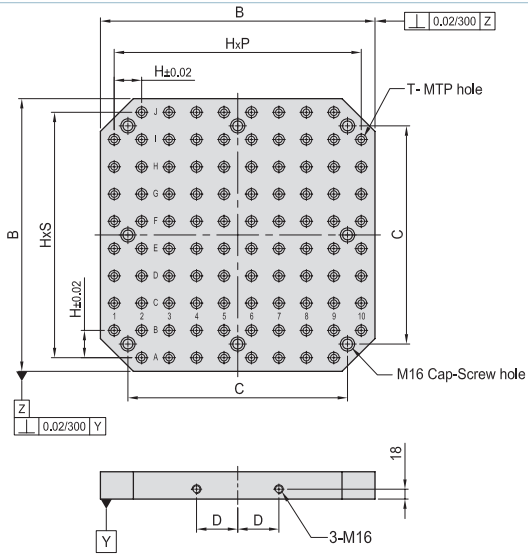

MODEL NO.	A	B	C	D	T	H	P	S	MTP	Mounting holes	kg	
BP05-50400-0400-12	50	400	320	55	Ø12	M12	50	7	7	59	4	54
BP05-50500-0500-12		500	400	75				9	9	93	8	83
BP05-50630-0630-12	50	630	500	100	Ø12	M12	50	11	11	139	8	135
BP05-50800-0800-12		800	640	135				15	15	237		206
BP05-50400-0400-16	50	400	320	55	Ø16	M16	50	7	7	59	4	52
BP05-50500-0500-16		500	400	75				9	9	93	8	80
BP05-50630-0630-16	50	630	500	100	Ø16	M16	50	11	11	139	8	130
BP05-50800-0800-16		800	640	135				15	15	237		204

\*Special Design Welcome !

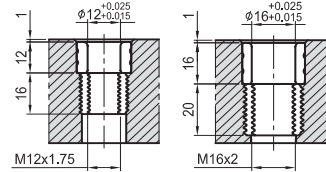

Figure T



## BP06

### MC基板 M/C BASE PLATE

材质: HT250/QT500  
 热处理: 退火  
 用处: 适用于卧式MC  
 优点: 以T型槽定位方式, 利用标准化治具零件, 可以快速组合完成一套符合需求的治具。

Material: Cast Iron HT250/QT500  
 Heat treated (Normalized)  
 Application: Horizontal Machining Center.  
 Features: T-Slots running in 2 directions, easily adapts to standardized jig components.

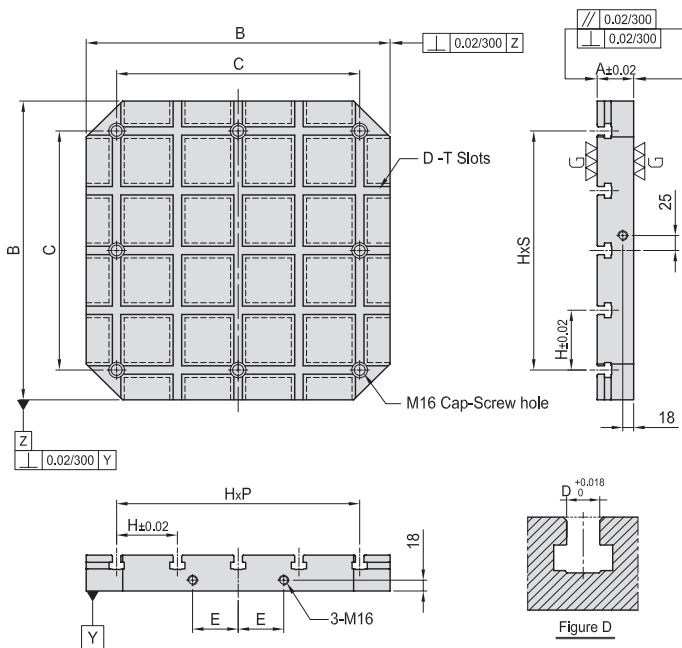

Figure D

MODEL NO.	A	B	C	D	E	H	P	S	Mounting holes	kg
BP06-60400-0400-14	60	400	320	14	55	80	4	4	4	56
BP06-60500-0500-14		500	400	75	100	8			90	
BP06-60630-0630-14	60	630	500	14	100	125	4	4	8	150
BP06-60800-0800-14		800	640	135	160	8			230	
BP06-75400-0400-18	75	400	320	18	55	80	4	4	4	68
BP06-75500-0500-18		500	400	75	100	8			108	
BP06-75630-0630-18	75	630	500	18	100	125	4	4	8	180
BP06-75800-0800-18		800	640	135	160	8			295	

\*Special Design Welcome !



# BP07

## MC四面基座 SQUARE TOOLING COLUMN

材质: HT250/QT500  
 热处理: 退火  
 用处: 适用于卧式MC  
 优点: 可以根据实际需求, 自行钻孔加工制作专用治具。

Material: Cast Iron HT250/QT500  
 Heat treated (Normalized)  
 Application: Horizontal Machining Center.  
 Features: Ready to accept a hole pattern for your sEye bolt & top cover included.

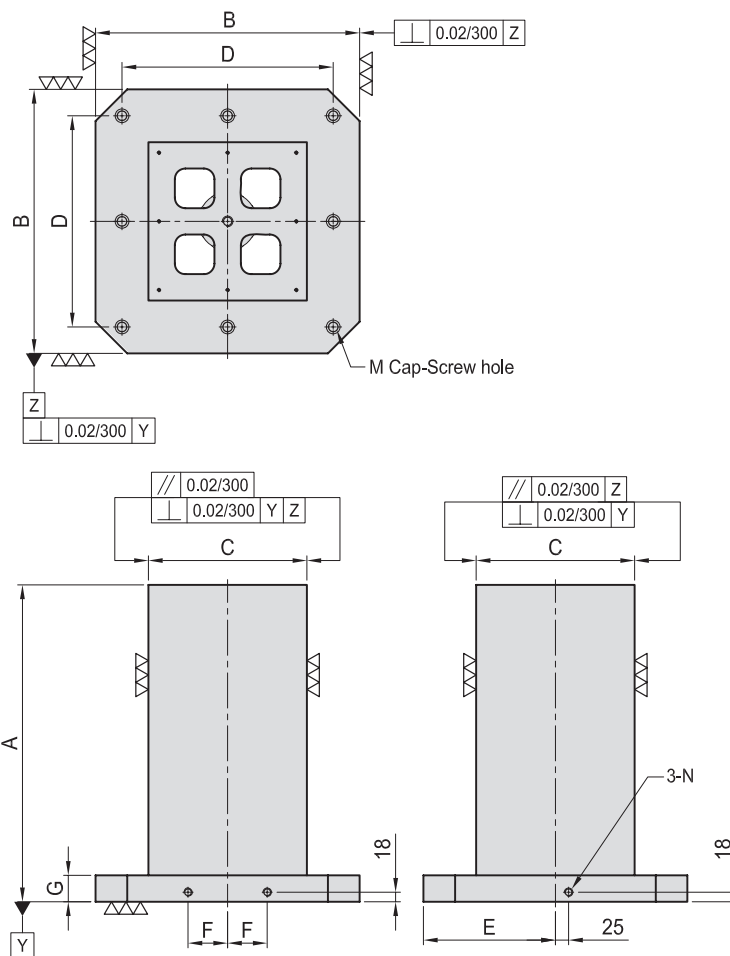

MODEL NO.	A	B	C	D	E	F	G	M	N	Mounting holes	kg
BP07-300300-0500	500	300	150	250	150	40	50	M12	M12	4	90
BP07-400400-0500	500	400	250	320	200	55	50	M16	M16	4	160
BP07-400400-0650	650										210
BP07-500500-0600	600	500	300	400	250	75	50	M16	M16	8	250
BP07-500500-0750	750										310
BP07-630630-0700	700	630	350	500	315	100	50	M16	M16	8	400
BP07-630630-0850	850										460
BP07-800800-0800	800	800	500	640	400	135	50	M16	M16	8	680
BP07-800800-1000	1000										800
BP07-10001000-1000	1000	1000	600	800	500	165	55	M20	M16	8	1164
BP07-10001000-1250	1250										1391

\*Special Design Welcome !



# BP08

## MC四面基座 SQUARE TOOLING COLUMN

材质: HT250/QT500  
 热处理: 退火  
 用处: 适用于卧式MC  
 优点: 以孔定位方式, 利用标准化治具零件, 可以快速组合成一套符合需求的治具。

Material: Cast Iron HT250/QT500  
 Heat treated (Normalized)  
 Application: Horizontal Machining Center.  
 Features: Alignment bushing & thread insert at every hole location, easily adapts to standardized jig components.

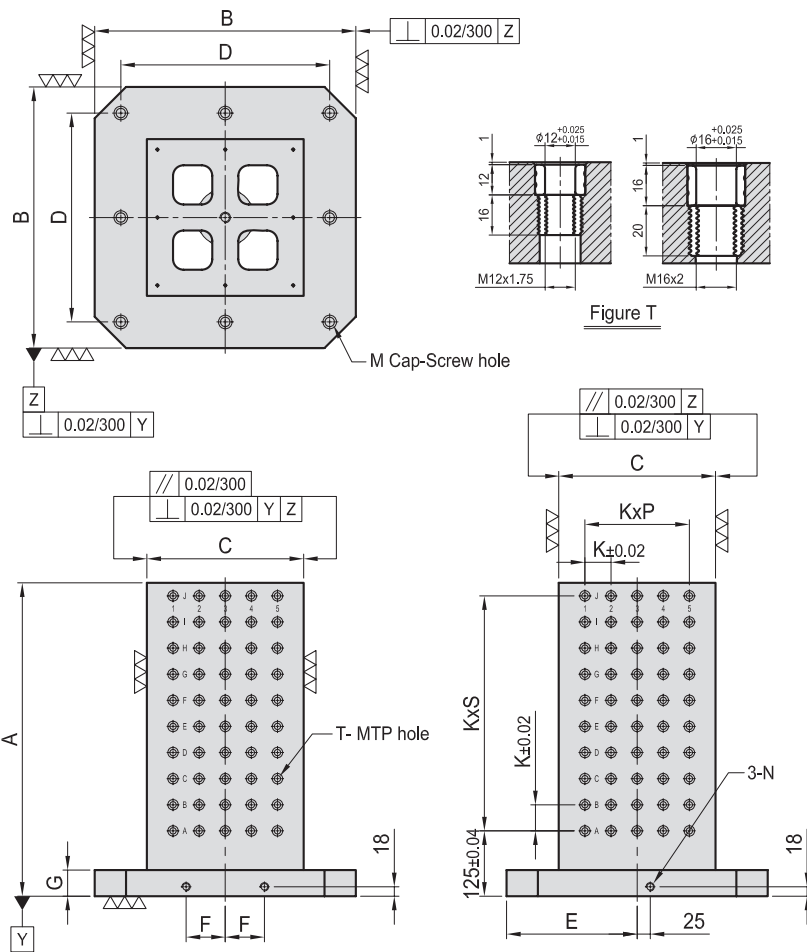

MODEL NO.	A	B	C	D	E	F	G	K	P	S	T	M	N	MTP	Mounting holes	kg	MODEL NO.	A	B	C	D	E	F	G	K	P	S	T	M	N	MTP	Mounting holes	kg		
BP08-300300-0500-12	500	300	150	250	150	40	50	50	1	7	Ø12	M12	M12	M12	64	4	90	BP08-300300-0500-16	500	300	150	250	150	40	50	50	1	7	Ø16	M16	M12	M12	64	4	90
BP08-400400-0500-12	500	400	250	320	200	55	50	50	3	7	Ø12	M12	M16	M16	128	4	155	BP08-400400-0500-16	500	400	250	320	200	55	50	50	3	7	Ø16	M16	M16	M16	128	4	152
BP08-400400-0650-12	650									10				176		200	BP08-400400-0650-16	650													176		195		
BP08-500500-0600-12	600	500	300	400	250	75	50	50	4	9	Ø12	M12	M16	M16	200	8	240	BP08-500500-0600-16	600	500	300	400	250	75	50	50	4	9	Ø16	M16	M16	M16	200	8	235
BP08-500500-0750-12	750									12				260		300	BP08-500500-0750-16	750												260		295			
BP08-630630-0700-12	700	630	350	500	315	100	50	50	5	11	Ø12	M12	M16	M16	288	8	360	BP08-630630-0700-16	700	630	350	500	315	100	50	50	5	11	Ø16	M16	M16	M16	288	8	365
BP08-630630-0850-12	850									14				360		445	BP08-630630-0850-16	850												360		440			
BP08-800800-0800-12	800	800	500	640	400	135	50	50	8	13	Ø12	M12	M16	M16	504	8	635	BP08-800800-0800-16	800	800	500	640	400	135	50	50	8	13	Ø16	M16	M16	M16	504	8	630
BP08-800800-1000-12	1000									17				648		780	BP08-800800-1000-16	1000												648		770			
BP08-10001000-1000-12	1000	1000	600	800	500	165	55	50	10	17	Ø12	M12	M20	M16	792	8	1164	BP08-10001000-1000-16	1000	1000	600	800	500	165	55	50	10	17	Ø16	M16	M20	M16	792	8	1164
BP08-10001000-1250-12	1250									22				1012		1391	BP08-10001000-1250-16	1250												1012		1391			

\*Special Design Welcome !



# BP09

## MC四面基座 SQUARE TOOLING COLUMN

材质: HT250/QT500  
 热处理: 退火  
 用处: 适用于卧式MC  
 优点: 以T型槽定位方式, 利用标准化治具零件, 可以快速组合完成一套符合需求的治具。

Material: Cast Iron HT250/QT500  
 Heat treated (Normalized)  
 Application: Horizontal Machining Center.  
 Features: T-Slots running in 2 directions, easily adapts to standardized jig components.

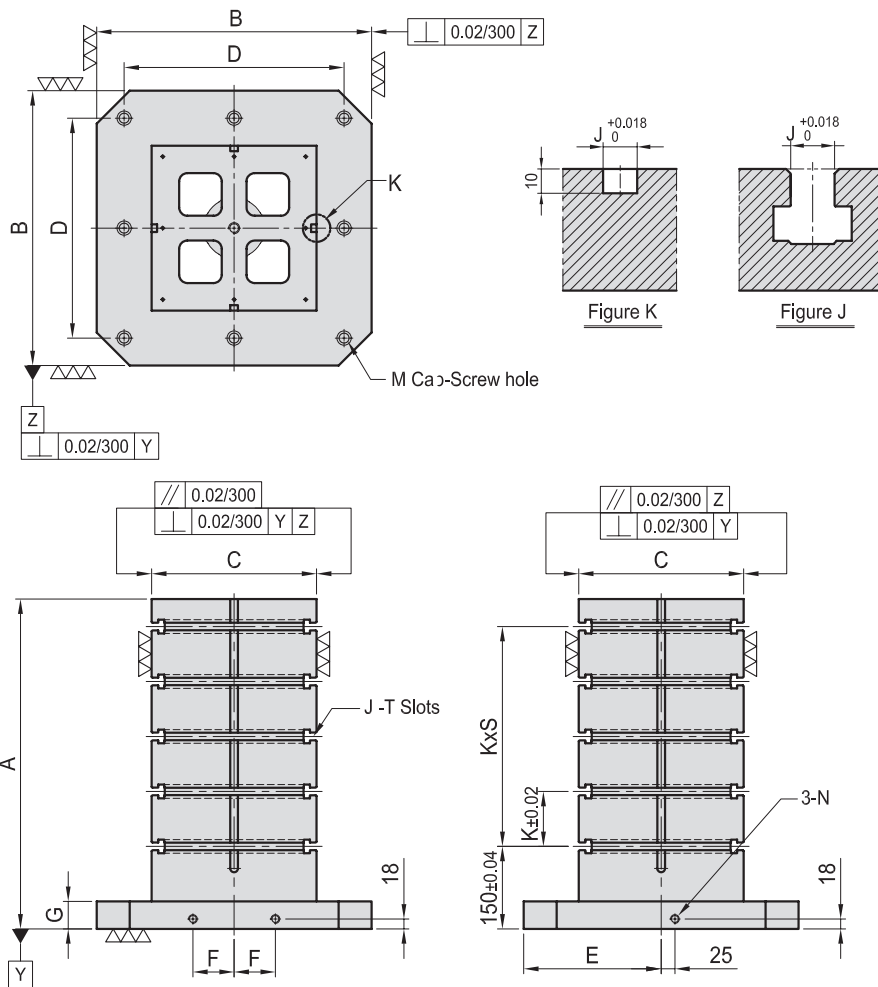

MODEL NO.	A	B	C	D	E	F	G	M	N	K	S	J	Mounting holes	kg	MODEL NO.	A	B	C	D	E	F	G	M	N	K	S	J	Mounting holes	kg
BP09-400400-0500-14	500	400	250	320	200	55	50	M16	M16	100	3	14	4	160	BP09-400400-0500-18	500	400	250	320	200	55	50	M16	M16	100	3	18	4	155
BP09-400400-0650-14	650														BP09-400400-0650-18	650													
BP09-500500-0600-14	600	500	300	400	250	75	50	M16	M16	100	4	14	8	270	BP09-500500-0600-18	600	500	300	400	250	75	50	M16	M16	100	4	18	8	265
BP09-500500-0750-14	750														BP09-500500-0750-18	750													
BP09-630630-0700-14	700	630	350	500	315	100	50	M16	M16	125	4	14	8	375	BP09-630630-0700-18	700	630	350	500	315	100	50	M16	M16	125	4	18	8	365
BP09-630630-0850-14	850														BP09-630630-0850-18	850													
BP09-800800-0800-14	800	800	500	640	400	135	50	M16	M16	150	4	14	8	655	BP09-800800-0800-18	800	800	500	640	400	135	50	M16	M16	150	4	18	8	638
BP09-800800-1000-14	1000														BP09-800800-1000-18	1000													
BP09-10001000-1000-14	1000	1000	600	800	500	165	55	M20	M16	160	5	14	8	1146	BP09-10001000-1000-18	1000	1000	600	800	500	165	55	M20	M16	160	5	18	8	1146
BP09-10001000-1250-14	1250														BP09-10001000-1250-18	1250													

\*Special Design Welcome !



## BP10

### MC双面基座

### DOUBLE SIDED TOOLING COLUMN

材质: HT250/QT500

热处理: 退火

用处: 适用于卧式MC

优点: 可以根据实际需求, 自行钻孔加工制作专用治具。

Material: Cast Iron HT250/QT500

Heat treated(Normalized)

Application: Horizontal Machining Center.

Features: Ready to accept a hole pattern for your sEye bolt & top cover included.

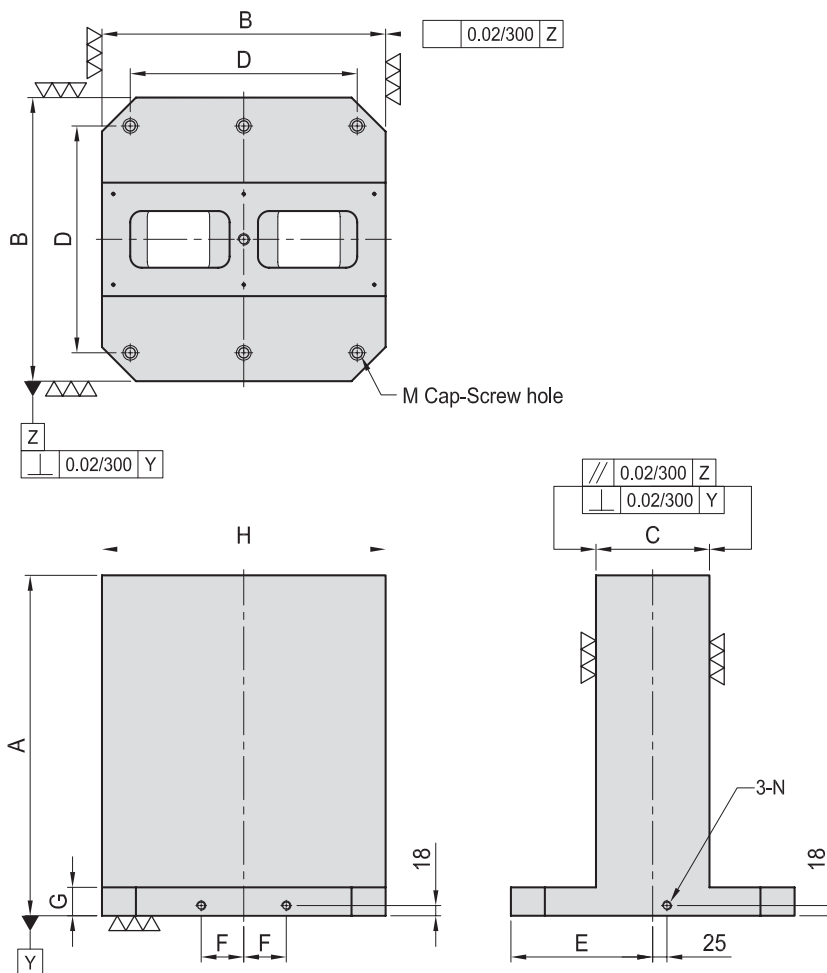

MODEL NO.	A	B	C	D	E	F	G	H	M	N	Mounting holes	kg
BP10-300300-0500	500	300	80	250	150	40	50	300	M12	M12	4	115
BP10-400400-0500	500	400	150	320	200	55	50	400	M16	M16	4	170
BP10-400400-0650	650											215
BP10-500500-0600	600	500	200	400	250	75	50	500	M16	M16	6	270
BP10-500500-0750	750											350
BP10-630630-0700	700	630	250	500	315	100	50	630	M16	M16	6	445
BP10-630630-0850	850											520
BP10-800800-0800	800	800	300	640	400	135	50	800	M16	M16	6	675
BP10-800800-1000	1000											815
BP10-10001000-1000	1000	1000	350	800	500	165	55	1000	M20	M16	6	1162
BP10-10001000-1250	1250											1377

\*Special Design Welcome !



# BP11

## MC双面基座 DOUBLE SIDED TOOLING COLUMN

材质: HT250/QT500  
 热处理: 退火  
 用处: 适用于卧式MC  
 优点: 以孔定位方式, 利用标准化治具零件, 可以快速组合成一套符合需求的治具。

Material: Cast Iron HT250/QT500  
 Heat treated (Normalized)  
 Application: Horizontal Machining Center.  
 Features: Alignment bushing & thread insert at every hole location, easily adapts to standardized jig components.

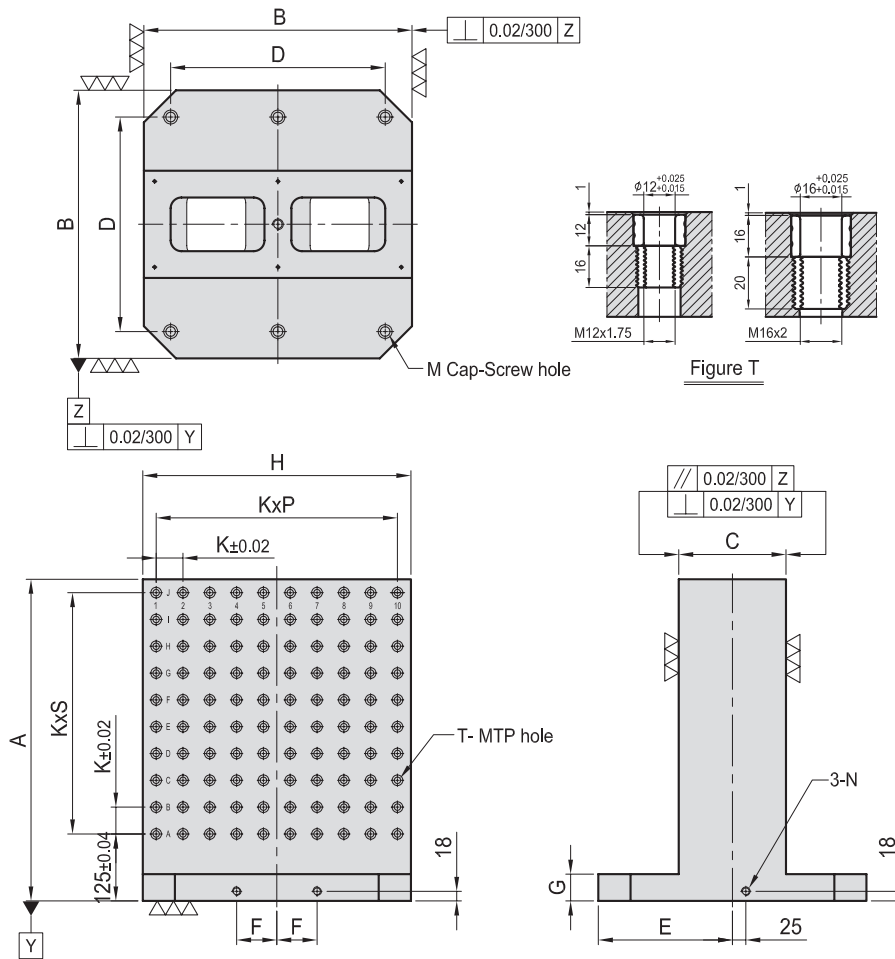

MODEL NO.	A	B	C	D	E	F	G	H	K	P	S	T	M	N	MTP	Mounting holes	kg	MODEL NO.	A	B	C	D	E	F	G	H	K	P	S	T	M	N	MTP	Mounting holes	kg	
BP11-300300-0500-12	500	300	80	250	150	40	50	300	50	5	7	Ø12	M12	M12	M12	96	4	BP11-300300-0500-16	500	300	80	250	150	40	50	300	50	5	7	Ø16	M16	M12	M12	96	4	105
BP11-400400-0500-12	500	400	150	320	200	55	50	400	50	7	7	Ø12	M12	M16	M16	128	4	BP11-400400-0500-16	500	400	150	320	200	55	50	400	50	7	7	Ø16	M16	M16	M16	128	4	160
BP11-400400-0650-12	650										10					176		BP11-400400-0650-16	650															205		
BP11-500500-0600-12	600	500	200	400	250	75	50	500	50	9	9	Ø12	M12	M16	M16	200	6	BP11-500500-0600-16	600	500	200	400	250	75	50	500	50	9	9	Ø16	M16	M16	M16	200	6	260
BP11-500500-0750-12	750										12					260		BP11-500500-0750-16	750															330		
BP11-630630-0700-12	700	630	250	500	315	100	50	630	50	11	11	Ø12	M12	M16	M16	288	6	BP11-630630-0700-16	700	630	250	500	315	100	50	630	50	11	11	Ø16	M16	M16	M16	288	6	430
BP11-630630-0850-12	850										14					360		BP11-630630-0850-16	850															505		
BP11-800800-0800-12	800	800	300	640	400	135	50	800	50	14	13	Ø12	M12	M16	M16	420	6	BP11-800800-0800-16	800	800	300	640	400	135	50	800	50	14	13	Ø16	M16	M16	M16	420	6	650
BP11-800800-1000-12	1000										17					540		BP11-800800-1000-16	1000															790		
BP11-10001000-1000-12	1000	1000	350	800	500	165	55	1000	50	18	17	Ø12	M12	M20	M16	684	6	BP11-10001000-1000-16	1000	1000	350	800	500	165	55	1000	50	18	17	Ø16	M16	M20	M16	684	6	1158
BP11-10001000-1250-12	1250										22					874		BP11-10001000-1250-16	1250																1375	

\*Special Design Welcome !





# BP12

## MC双面基座

## DOUBLE SIDED TOOLING COLUMN

材质: HT250/QT500

热处理: 退火

用处: 适用于卧式MC

优点: 以T型槽定位方式, 利用标准化治具零件, 可以快速组合完成一套符合需求的治具。

Material: Cast Iron HT250/QT500

Heat treated(Normalized)

Application: Horizontal Machining Center.

Features: T-Slots running in 2 directions, easily adapts to standardized jig components.

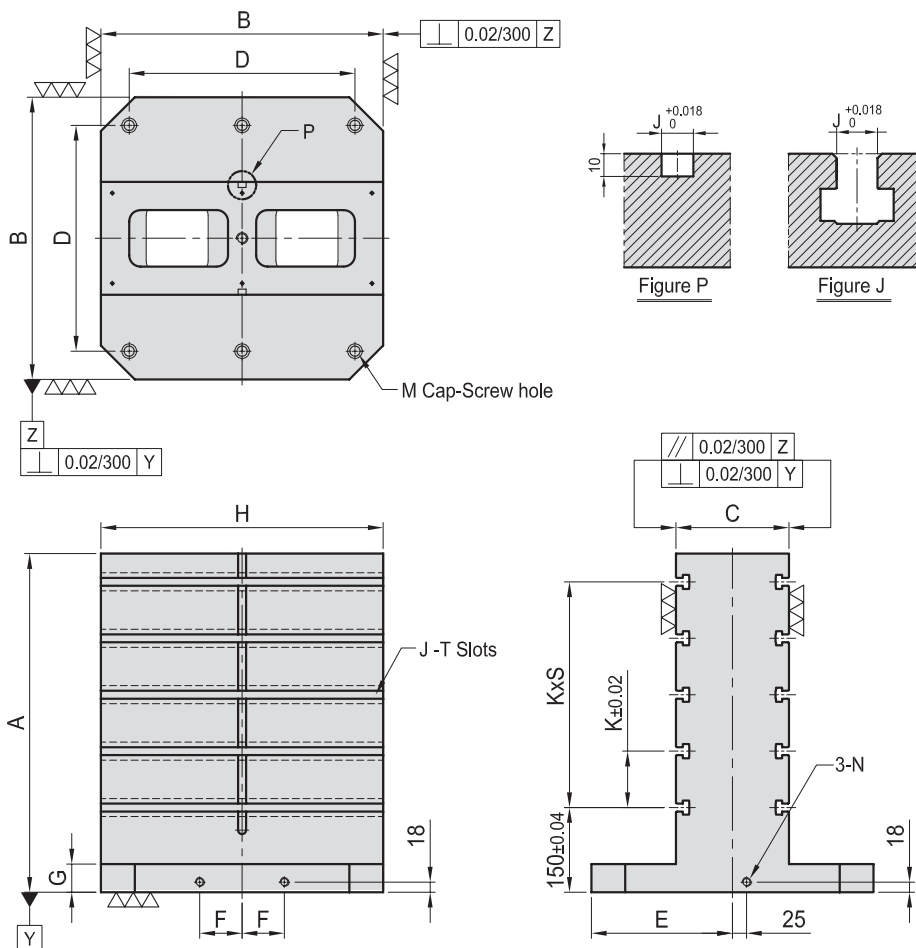

MODEL NO.	A	B	C	D	E	F	G	M	N	H	J	K	S	Mounting holes	kg	MODEL NO.	A	B	C	D	E	F	G	M	N	H	J	K	S	Mounting holes	kg
BP12-400400-0500-14	500	400	150	320	200	55	50	M16	M16	400	14	100	3	4	170	BP12-400400-0500-18	500	400	150	320	200	55	50	M16	M16	400	18	100	3	4	165
BP12-400400-0650-14	650												4	220	BP12-400400-0650-18	650											4	210			
BP12-500500-0600-14	600	500	200	400	250	75	50	M16	M16	500	14	100	4	6	290	BP12-500500-0600-18	600	500	200	400	250	75	50	M16	M16	500	18	100	4	6	280
BP12-500500-0750-14	750												5	335	BP12-500500-0750-18	750										5	325				
BP12-630630-0700-14	700	630	250	500	315	100	50	M16	M16	630	14	125	4	6	440	BP12-630630-0700-18	700	630	250	500	315	100	50	M16	M16	630	18	125	4	6	430
BP12-630630-0850-14	850												5	515	BP12-630630-0850-18	850										5	500				
BP12-800800-0800-14	800	800	300	640	400	135	50	M16	M16	800	14	150	4	6	670	BP12-800800-0800-18	800	800	300	640	400	135	50	M16	M16	800	18	150	4	6	660
BP12-800800-1000-14	1000												5	790	BP12-800800-1000-18	1000										5	785				
BP12-10001000-1000-14	1000	1000	350	800	500	165	55	M20	M16	1000	14	160	5	6	1158	BP12-10001000-1000-18	1000	1000	350	800	500	165	55	M20	M16	1000	18	160	5	6	1158
BP12-10001000-1250-14	1250												6	1375	BP12-10001000-1250-18	1250										6	1375				

\*Special Design Welcome !



## BP13

### MC替换式双面基座 MODULAR TOOLING COLUMN

材质: HT250/QT500  
热处理: 退火  
用处: 卧式MC  
优点: 模块化快换系统, 简易3点安装, 与BP14和BP15一起使用。

Material: Cast Iron HT250/QT500  
Heat treated(Normalized)  
Application: Horizontal Machining Center.

Features: Modular quick-change system, simple 3 point mounting, use with BP14 & BP15 subplates. Eye bolt, top cover & side covers included

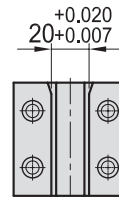
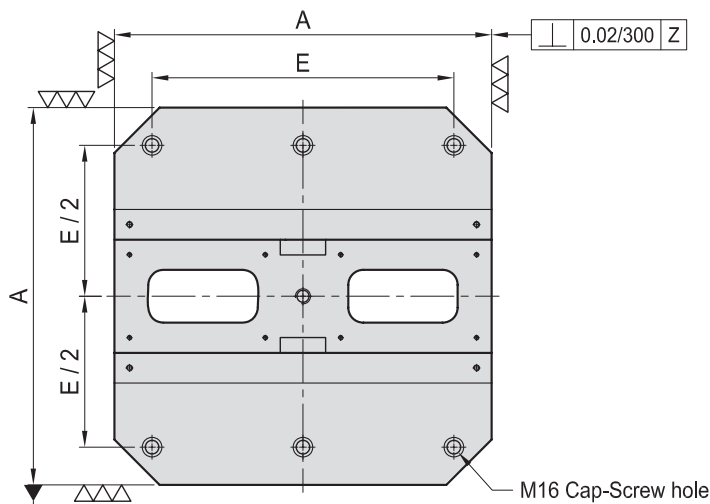
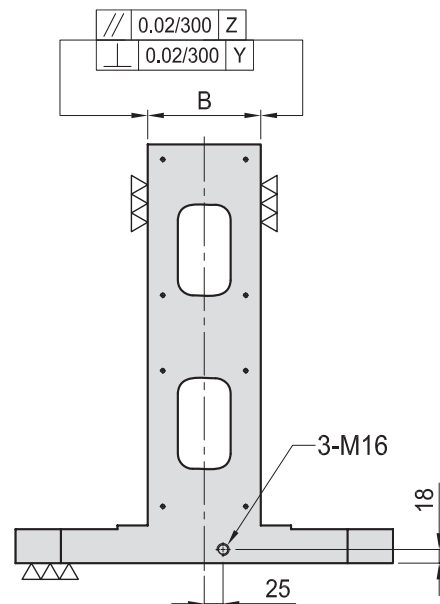
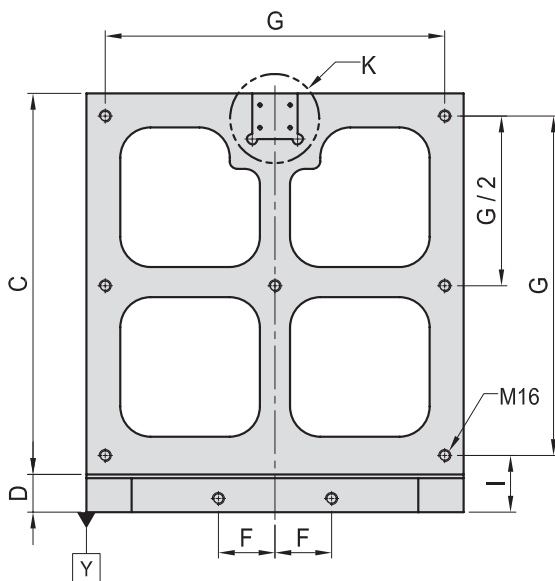
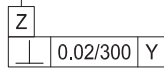

Figure K



MODEL NO.	A	B	C	D	E	F	G	I	Mounting holes	kg
BP13-400400-0450	400	130	400	50	320	55	350	70	4	125
BP13-500500-0555	500	150	500	55	400	75	450	75	6	178
BP13-630630-0690	630	220	630	60	500	100	580	80	6	350
BP13-800800-0860	800	250	800	60	640	135	750	80	6	515

\*Special Design Welcome !



## BP14

### 辅助板 SUB-PLATE

材质: HT250/QT500  
 热处理: 退火  
 用处: 用于替换双面基座, 与BP13配套使用。  
 优点: 可以根据实际需求, 自行钻孔加工制作专用治具。

Material: Cast Iron HT250/QT500  
 Heat treated (Normalized)  
 Application: Modular quick change subplate, use with BP13.  
 Features: Ready to accept a hole pattern for your special jig.

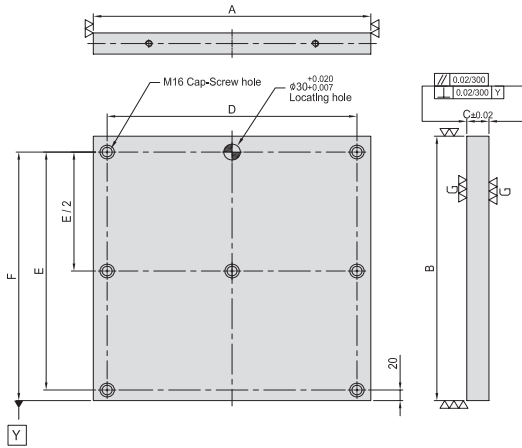

MODEL NO.	A	B	C	D	E	F	Mounting holes	kg
BP14-40400-0400	400	400	40	350	350	370	5	46
BP14-40500-0500	500	500	40	450	450	470	7	72
BP14-40630-0630	630	630	40	580	580	600	7	114
BP14-50800-0800	800	800	50	750	750	770	7	232

\*Special Design Welcome !

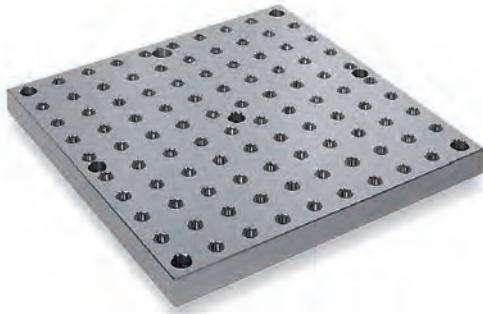

## BP15

### 辅助板 SUB-PLATE

材质: HT250/QT500  
 热处理: 退火  
 用处: 用于替换双面基座, 与BP13配套使用。  
 优点: 以孔定位方式, 利用标准化治具零件, 可以快速组合成一套符合需求的治具。

Material: Cast Iron HT250/QT500  
 Heat treated (Normalized)  
 Application: Modular quick change subplate, use with BP13.  
 Features: Alignment bushing & thread insert at every hole location, easily adapts to standardized jig components.

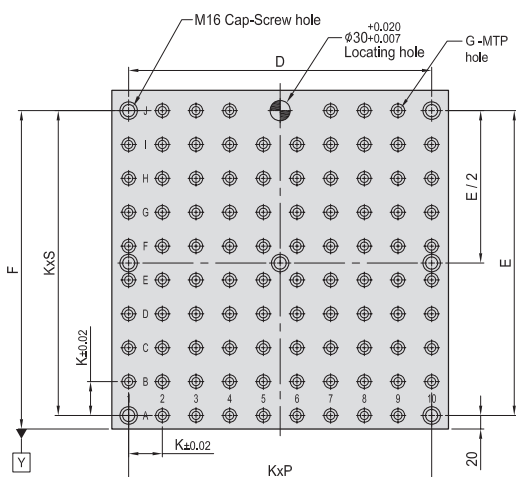
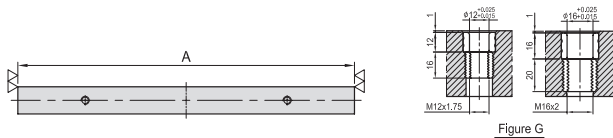

MODEL NO.	A	B	C	D	E	F	K	P	S	G	MTP	Mounting holes	kg	
BP15-40400-0400-12	400	400	40	350	350	370	50	7	7	Ø12	M12	58	5	42
BP15-40500-0500-12	500	500	40	450	450	470	50	9	9	Ø12	M12	94	7	69
BP15-40630-0630-12	630	630	40	580	580	600	50	11	11	Ø12	M12	138	7	108
BP15-50800-0800-12	800	800	50	750	750	770	50	15	15	Ø12	M12	250	7	220

MODEL NO.	A	B	C	D	E	F	K	P	S	G	MTP	Mounting holes	kg	
BP15-40400-0400-16	400	400	40	350	350	370	50	7	7	Ø16	M16	58	5	41
BP15-40500-0500-16	500	500	40	450	450	470	50	9	9	Ø16	M16	90	7	67
BP15-40630-0630-16	630	630	40	580	580	600	50	11	11	Ø16	M16	138	7	105
BP15-50800-0800-16	800	800	50	750	750	770	50	15	15	Ø16	M16	246	7	215

## BP16

### 圆形基板 ROUND BASE PLATE



材质: HT250/QT500  
热处理: 退火  
用处: 适用于NC分度盘  
优点: 可根据需要, 自行钻孔加工制作专用治具。

Material: Cast Iron HT250/QT500  
Heat treated(Normalized)  
Application: NC Rotary Table or Indexer.  
Features: Ready to accept a hole pattern for your special jig.

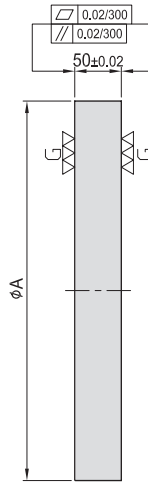
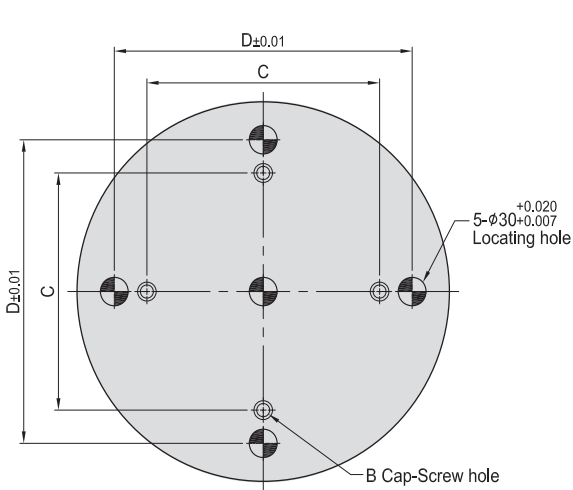

MODEL NO.	A	B	C	D	kg
BP16-50-0300	300	M12	150	220	25
BP16-50-0400	400		250	320	40
BP16-50-0500	500	M16	300	400	65
BP16-50-0600	600		400	500	95

\*Special Design Welcome !

## BP17

### 圆形基板 ROUND BASE PLATE



材质: HT250/QT500  
热处理: 退火  
用处: 适用于NC分度盘  
优点: 以孔定位方式, 利用标准化治具零件, 可以快速组合成一套符合需求的治具。

Material: Cast Iron HT250/QT500  
Heat treated(Normalized)  
Application: NC Rotary Table or Indexer.  
Features: Alignment bushing & thread insert at every hole location, easily adapts to standardized jig components.

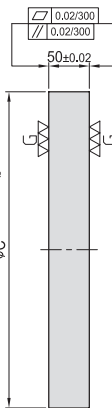
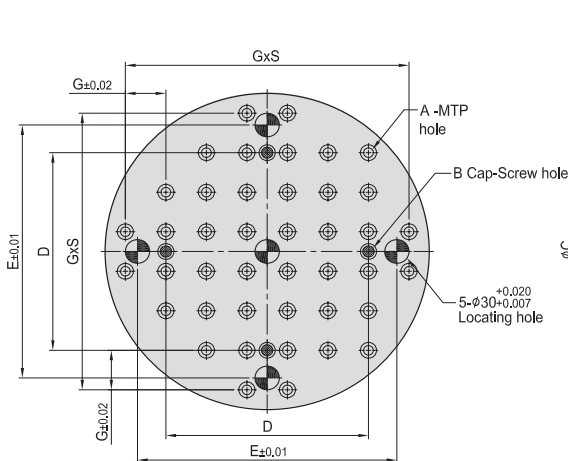

MODEL NO.	A	B	C	D	E	G	S	MTP	kg	
BP17-50-0300-12	Ø12	M12	M12	300	150	220	50	5	24	23
BP17-50-0400-12				400	250	320		7	44	42
BP17-50-0500-12	Ø12	M12	M16	500	300	400	50	9	68	70
BP17-50-0600-12				600	400	500		11	96	98
BP17-50-0500-16	Ø16	M16	M16	500	300	400	50	9	68	68
BP17-50-0600-16				600	400	500		11	96	95

\*Special Design Welcome !

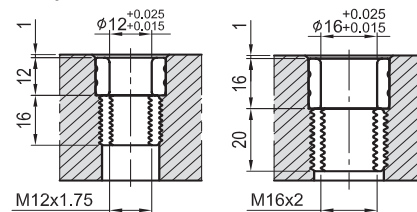
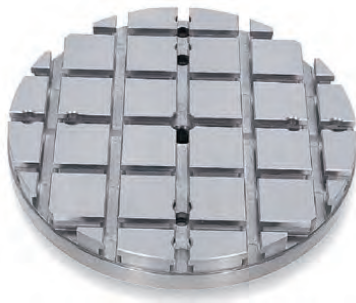

Figure A



## BP18

### 圆形基板 ROUND BASE PLATE

材质: HT250/QT500  
 热处理: 退火  
 用处: 适用于NC分度盘  
 优点: 以T型槽定位方式, 利用标准化治具零件, 可以快速组合完成一套符合需求的治具。

Material: Cast Iron HT250/QT500  
 Heat treated(Normalized)  
 Application: NC Rotary Table or Indexer.  
 Features: T-Slots running in 2 directions, easily adapts to standardized jig components

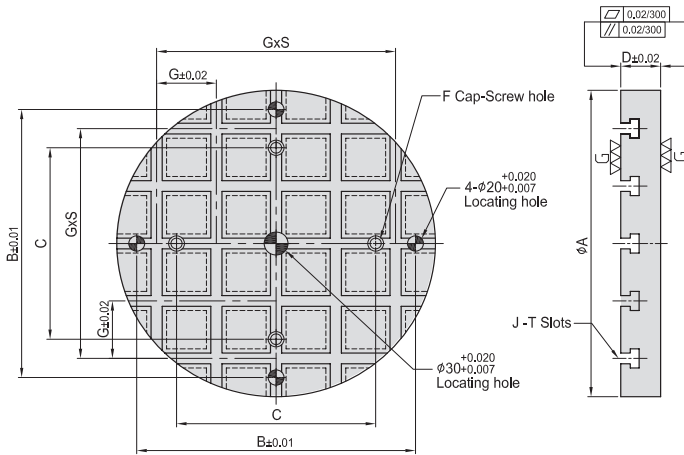

MODEL NO.	A	B	C	D	F	G	S	J	kg
BP18-50-0300-14	300	250	150	50	M12	75	2	14	22
BP18-50-0400-14	400	350	250						4
BP18-65-0500-18	500	450	300	65	M16	100	4	18	74
BP18-65-0600-18	600	550	400						110

\*Special Design Welcome !

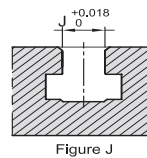

## BP19

### 辅助板 SUB-PLATE

材质: 45号钢  
 热处理: 渗碳淬火  
 用处: 适用于各种基板和基座  
 优点: 以T型槽定位方式, 利用标准化治具零件, 可以快速组合完成一套符合需求的治具。

Material: 45#  
 Application: Multipurpose subplate  
 Features: Ready to accept a hole pattern for your special jig

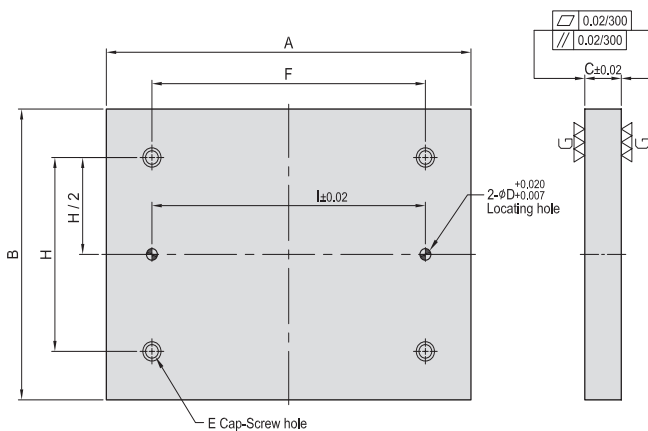

MODEL NO.	A	B	C	D	E	F	H	I	kg
BP19-30150-0200-12	200	150	30	12	M12	100	100	100	8.0
BP19-30150-0300-12	300					200			200
BP19-30200-0200-12	200	200	30	12	M12	100	100	100	9.5
BP19-30200-0300-12	300					200			200
BP19-30300-0300-12	300	300	30	12	M12	200	200	200	21.5
BP19-40300-0400-12	400					40			300
BP19-40400-0400-12	400	400	40	12	M12	300	300	300	51.0
BP19-40400-0500-12	500					400			400

MODEL NO.	A	B	C	D	E	F	H	I	kg
BP19-30150-0200-16	200	150	30	16	M16	100	100	100	8.0
BP19-30150-0300-16	300					200			200
BP19-30200-0200-16	200	200	30	16	M16	100	100	100	9.5
BP19-30200-0300-16	300					200			200
BP19-30300-0300-16	300	300	30	16	M16	200	200	200	21.5
BP19-40300-0400-16	400					40			300
BP19-40400-0400-16	400	400	40	16	M16	300	300	300	51.0
BP19-40400-0500-16	500					400			400

# BP20

## MC直角基座 M/C ANGLE PLATE



材质: HT250/QT500  
 热处理: 退火  
 用处: 适用于卧式MC  
 优点: 可以根据实际需求, 自行钻孔加工制作专用治具。

Material: Cast Iron HT250/QT500  
 Heat treated (Normalized)  
 Application: HMC/VMC.  
 Features: Ready to accept a hole pattern for your special jig.

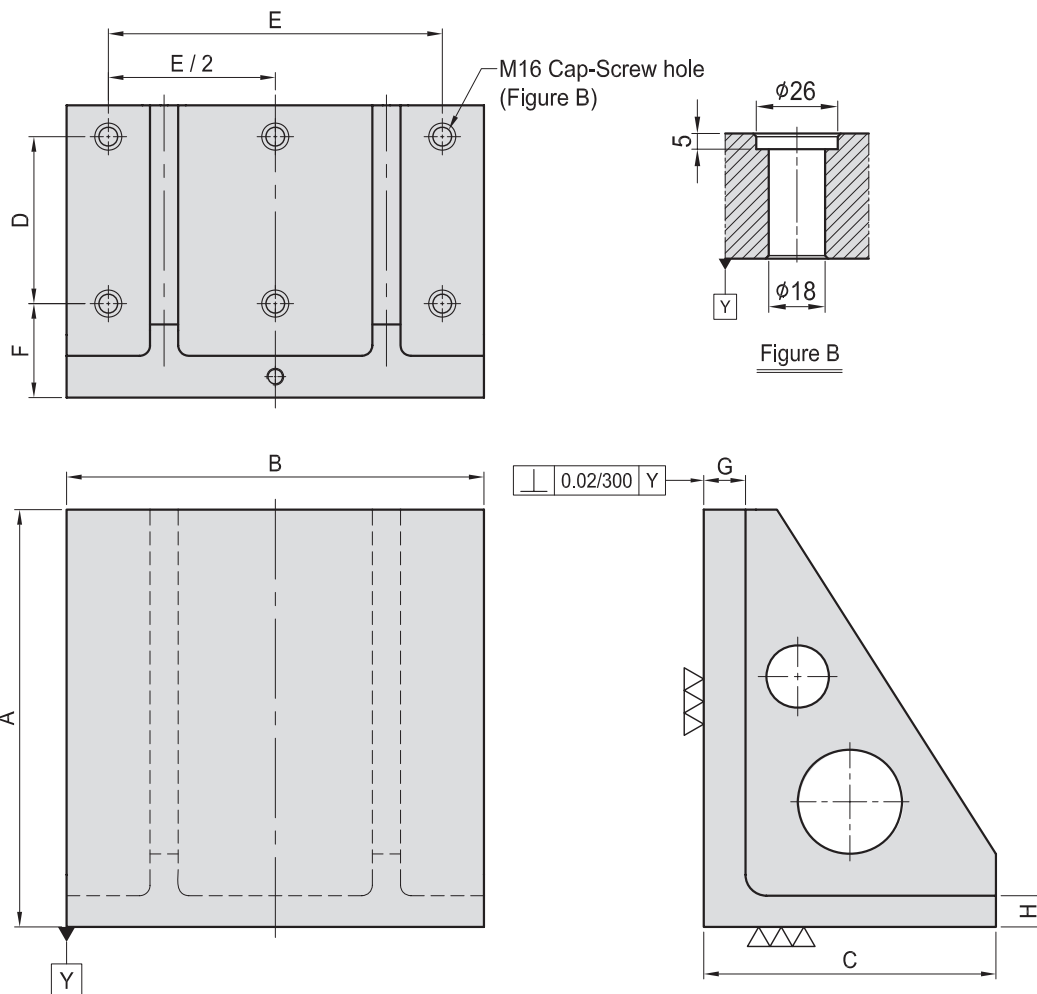

MODEL NO.	A	B	C	D	E	F	G	H	Mounting holes	kg
BP20-220300-0300	300	300	220	100	250	90	40	30	6	50
BP20-280400-0400	400	400	280	160	320					90
BP20-340500-0500	500	500	340	200	400	100	50	35	6	165
BP20-435630-0630	630	630	435	250	500					40
BP20-525800-0800	800	800	525	320	640	115	50	45	6	475

\*Special Design Welcome !

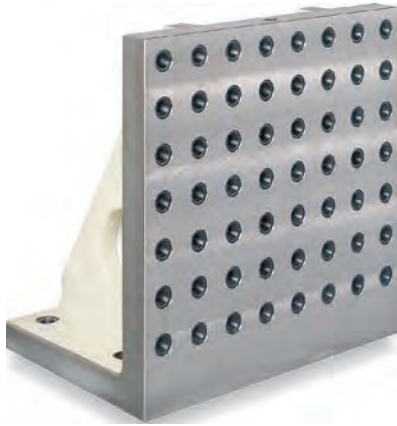

# BP21

## MC直角基座 M/C ANGLE PLATE

热处理: 退火  
 用处: 适用于卧式MC  
 优点: 以孔定位方式, 利用标准化治具零件, 可以快速组合成一套符合需求的治具。

Material: Cast Iron HT250/QT500  
 Heat treated (Normalized)  
 Application: Horizontal Machining Center.

Features: Alignment bushing & thread insert at every hole location, easily adapts to standardized jig components.

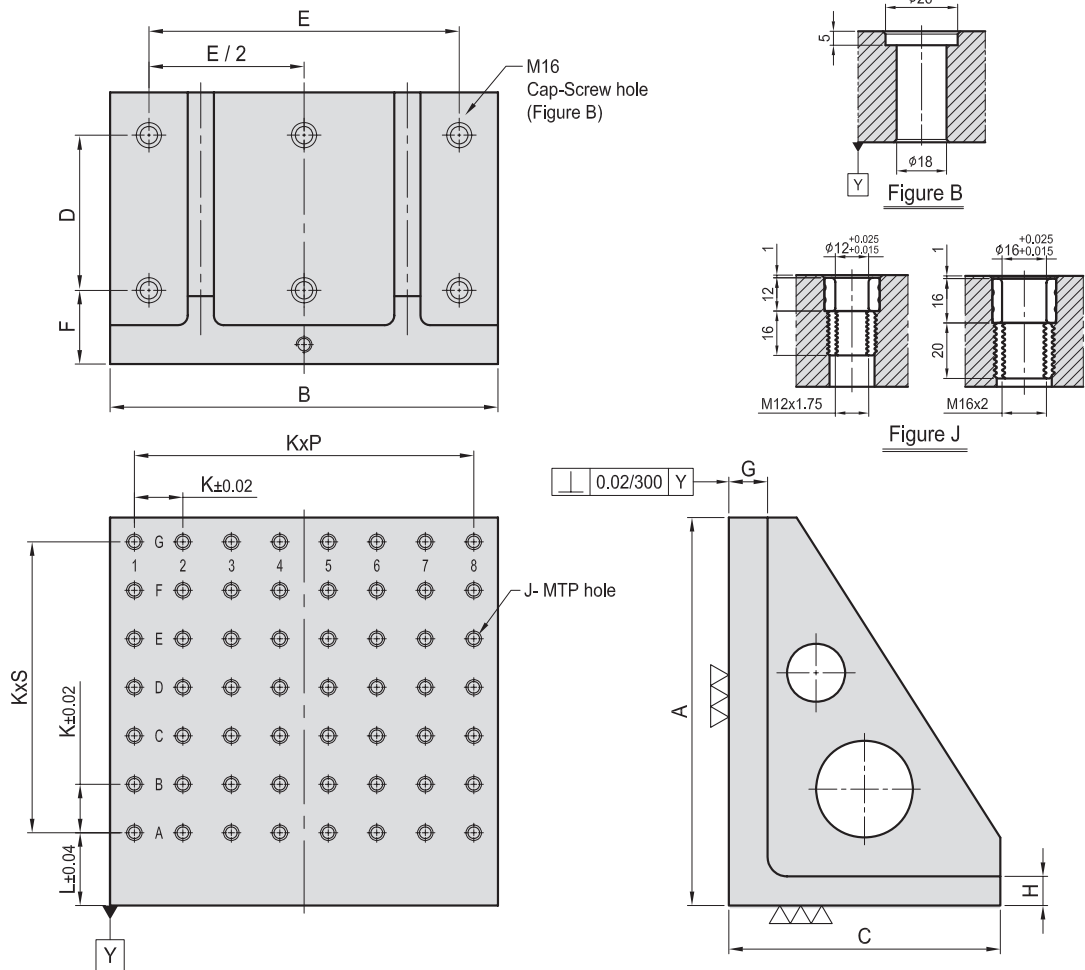

MODEL NO.	A	B	C	D	E	F	G	H	J	K	L	P	S	MTP	Mounting holes	kg	
BP21-220300-0300-12	300	300	220	100	250	90	40	30	$\phi 12$	M12	50	75	5	4	30	6	50
BP21-280400-0400-12	400	400	280	160	320								7	6	56		
BP21-340500-0500-12	500	500	340	200	400	90	50	35	$\phi 12$	M12	50	75	9	8	90	6	173
BP21-435630-0630-12	630	630	435	250	500								100	40	40		
BP21-525800-0800-12	800	800	525	320	640	115	50	45	$\phi 12$	M12	50	75	15	14	240	6	477
BP21-220300-0300-16	300	300	220	100	250	90	40	30	$\phi 16$	M16	50	75	5	4	30	6	46
BP21-280400-0400-16	400	400	280	160	320								7	6	56		
BP21-340500-0500-16	500	500	340	200	400	90	50	35	$\phi 16$	M16	50	75	9	8	90	6	170
BP21-435630-0630-16	630	630	435	250	500								100	40	40		
BP21-525800-0800-16	800	800	525	320	640	115	50	45	$\phi 16$	M16	50	75	15	14	240	6	470

\*Special Design Welcome !



## BP22

### MC直角基座 M/C ANGLE PLATE

材质: HT250/QT500

热处理: 退火

用处: 适用于卧式MC

优点: 以T型槽定位方式, 利用标准化治具零件, 可以快速组合完成一套符合需求的治具。

Material: Cast Iron HT250/QT500

Heat treated(Normalized)

Application: Horizontal Machining Center.

Features: T-Slots running in 2 directions, easily adapts to standardized jig components.

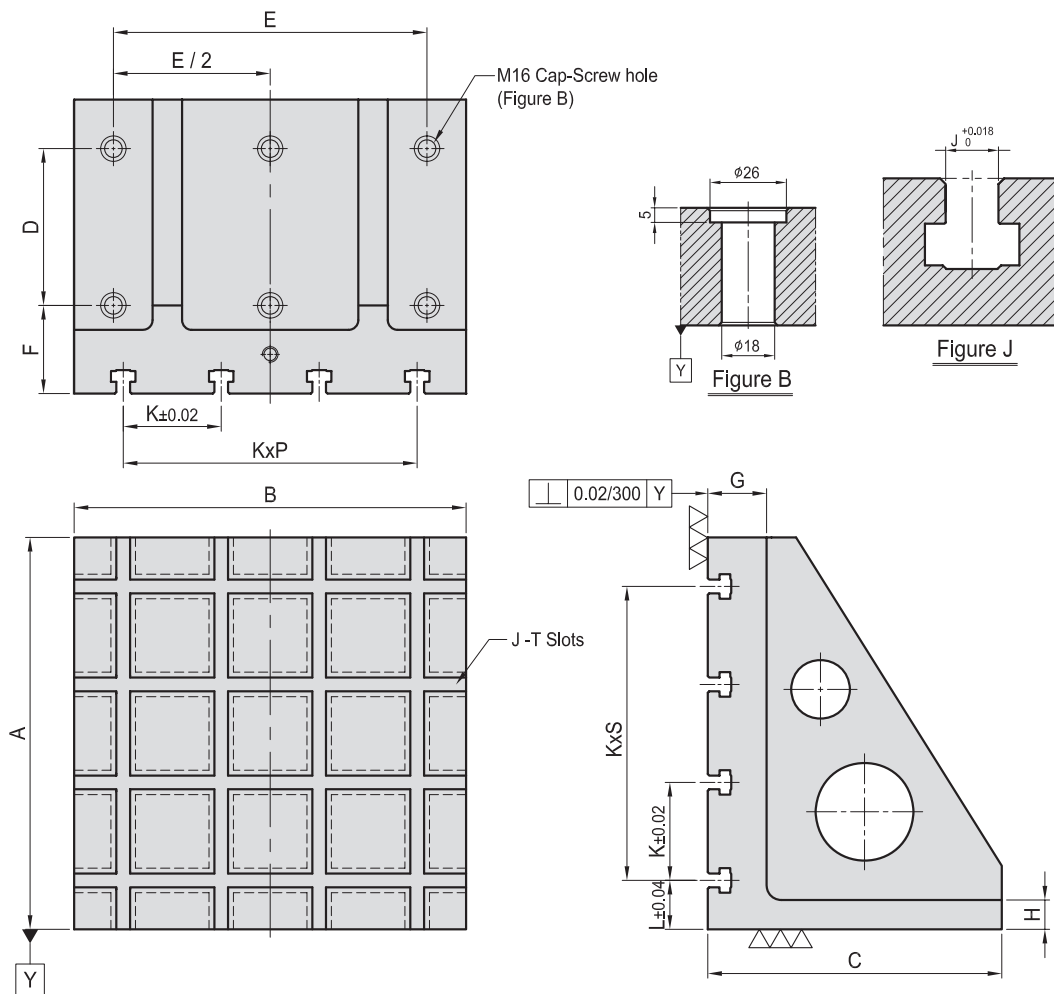

MODEL NO.	A	B	C	D	E	F	G	H	J	K	L	P	S	Mounting holes	kg
BP22-220300-0300-14	300	300	220	100	250	90	60	30	14	100	50	2	2	6	53
BP22-300400-0400-14	400	400	300	160	320							3	3		
BP22-350500-0500-14	500	500	350	200	400	100	65	40	14	100	50	4	4	6	170
BP22-450630-0630-14	630	630	450	250	500										
BP22-550800-0800-14	800	800	550	320	640	115	75	45	14	150	100	4	4	6	566
BP22-220300-0300-18	300	300	220	100	250	90	60	30	18	100	50	2	2	6	51
BP22-300400-0400-18	400	400	300	160	320							3	3		
BP22-350500-0500-18	500	500	350	200	400	100	65	40	18	100	50	4	4	6	162
BP22-450630-0630-18	630	630	450	250	500										
BP22-550800-0800-18	800	800	550	320	640	115	75	45	18	150	100	4	4	6	555

\*Special Design Welcome !





## BP23

### MC直角基座 MC NARROW ANGLE PLATE

材质: HT250/QT500  
热处理: 退火  
用处: 适用于卧式和立式MC  
优点: 可以根据实际需求, 自行钻孔加工制作专用治具。

Material: Cast Iron HT250/QT500  
Heat treated (Normalized)  
Application: HMC/VMC.  
Features: Ready to accept a hole pattern for your special jig.

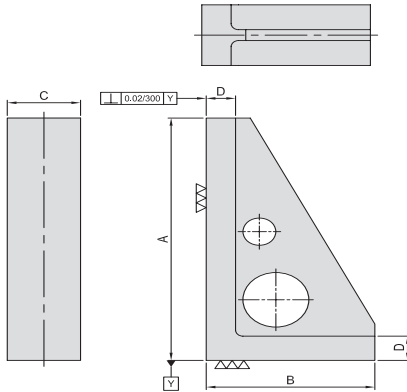

MODEL NO.	A	B	C	D	kg
BP23-180100-0300	300	180	100	40	14
BP23-230100-0400	400	230	100	40	20
BP23-280100-0500	500	280	100	40	25

\*Special Design Welcome !



## BP24

### MC直角基座 MC NARROW ANGLE PLATE

材质: HT250/QT500  
热处理: 退火  
用处: 适用于立式和立式MC  
优点: 以孔定位方式, 利用标准化治具零件, 可以快速组合成一套符合需求的治具。

Material: Cast Iron HT250/QT500  
Heat treated (Normalized)  
Application: HMC/VMC.  
Features: Alignment bushing & thread insert at every hole location, easily adaptS to standardized jig components.

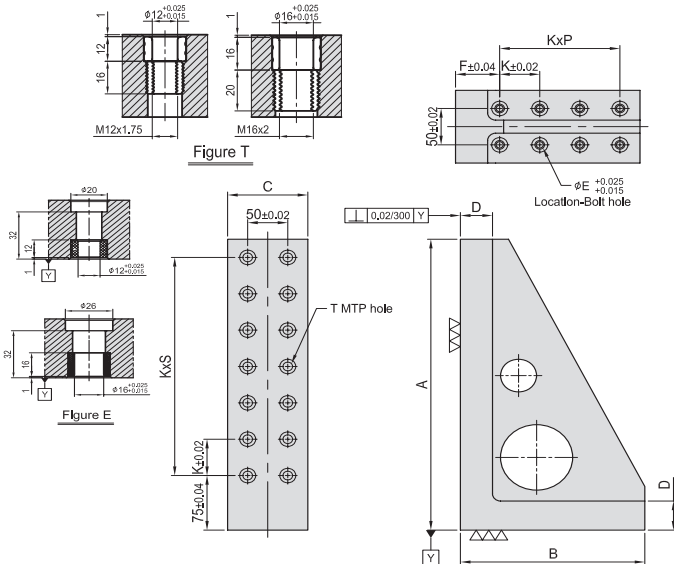

MODEL NO.	A	B	C	D	E	F	K	P	S	T	MTP	Mounting holes	kg	
BP24-180100-0300-12	300	180						2	4		10	6	12	
BP24-230100-0400-12	400	230	100	40	12	55	50	3	6	Ø12	M12	14	8	19
BP24-280100-0500-12	500	280						4	8			18	10	23
BP24-180100-0300-16	300	180						2	4			10	6	13
BP24-230100-0400-16	400	230	100	40	16	55	50	3	6	Ø16	M16	14	8	20
BP24-280100-0500-16	500	280						4	8			18	10	24

\*Special Design Welcome !

## BP25



### 方块垫铁 RECTANGULAR CAST SECTION

材质: HT250/QT500  
热处理: 退火  
用处: 适用于基板和基座上  
优点: 可以根据需要自行钻孔加工制作治具。

Material: Cast Iron HT250/QT500  
Heat treated(Normalized)  
Application: Cast sections provide a fast & economical way to make special jig components.  
Features: Ready to accept a hole pattern for your special jig.

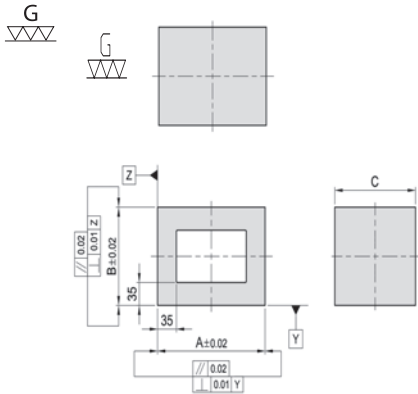

MODEL NO.	A	B	C	kg
BP25-200150-0150	200	150	150	23
BP25-250150-0200	250	200	150	30
BP25-300200-0250	300	250	200	56

\*Special Design Welcome !

## BP26



### 方块垫铁 RECTANGULAR CAST SECTION

材质: HT250/QT500  
热处理: 退火  
用处: 适用于基板和基座上  
优点: 因为工件的高低不同给与辅助用, 以孔定位方式, 利用标准化治具零件根据实际需求自由组合。

Material: Cast Iron HT250/QT500  
Heat treated(Normalized)  
Application: Cast sections provide a fast & economical way to make special jig components.  
Features: Alignment bushing & thread insert at every hole location, easily adapts to standardized jig components.

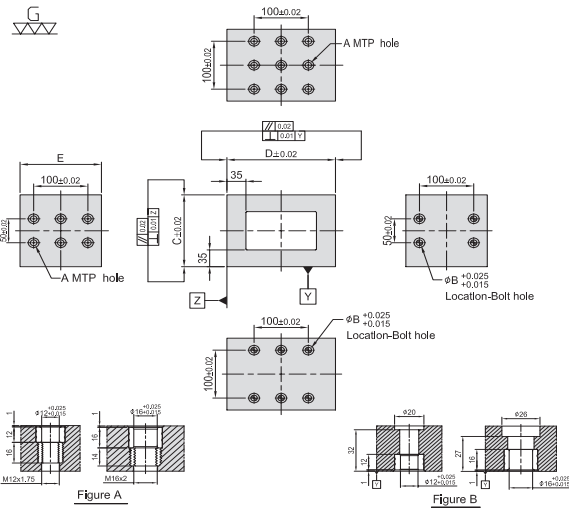

MODEL NO.	A	B	C	D	E	MTP	Mounting holes	kg	
BP26-200150-0150-12	Ø12	M12	12	150	200	150	15	10	23
BP26-250150-0200-12			200	250	21		14	28	
BP26-200150-0150-16	Ø16	M16	16	150	200	150	15	10	29
BP26-250150-0200-16			200	250	21		14	30	

\*Special Design Welcome !

# BP27

## 方块垫铁 RECTANGULAR CAST SECTION



材质: HT250/QT500  
热处理: 退火  
用处: 适用于基板和基座上  
优点: 可以根据需要自行钻孔加工制作治具。

Material: Cast Iron HT250/QT500  
Heat treated(Normalized)  
Application: Cast sections provide a fast & economical way to make special jig components.  
Features: Ready to accept a hole pattern for your special jig.

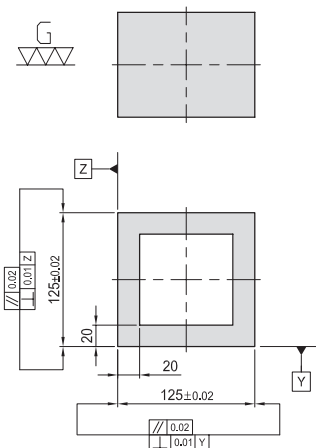

MODEL NO.	kg
BP27-125098-125	6

\*Special Design Welcome !

# BP28

## 方块垫铁 RECTANGULAR CAST SECTION



材质: HT250/QT500  
热处理: 退火  
用处: 适用于基板和基座上  
优点: 因为工件的高低不同给与辅助用, 以孔定位方式, 利用标准化治具零件根据实际需求自由组合。

Material: Cast Iron HT250/QT500  
Heat treated(Normalized)  
Application: Cast sections provide a fast & economical way to make special jig components.  
Features: Alignment bushing & thread insert at every hole location, easily adapts to standardized jig components.

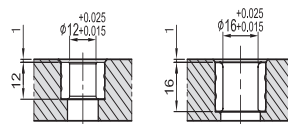
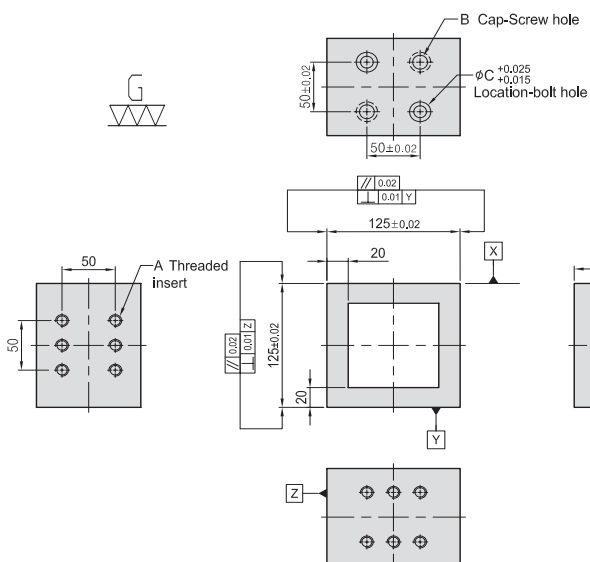

Figure C

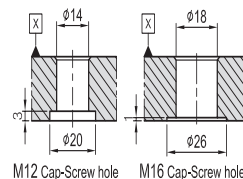

Figure B

MODEL NO.	A	B	C	kg
BP28-125098-125-12	M12	M12	12	5.8
BP28-125098-125-16	M16	M16	16	5.5

\*Special Design Welcome !



**BP29**

**MC十字基座  
CROSS TOOLING COLUMN**

材质: HT250/QT500  
 热处理: 退火  
 用处: 适用于卧式和立式MC  
 优点: 可以根据实际需求, 自行钻孔加工制作专用治具。

Material: Cast Iron HT250/QT500  
 Heat treated(Normalized)  
 Application: HMC/VMC.  
 Features: Ready to accept a hole pattern for your special jig.

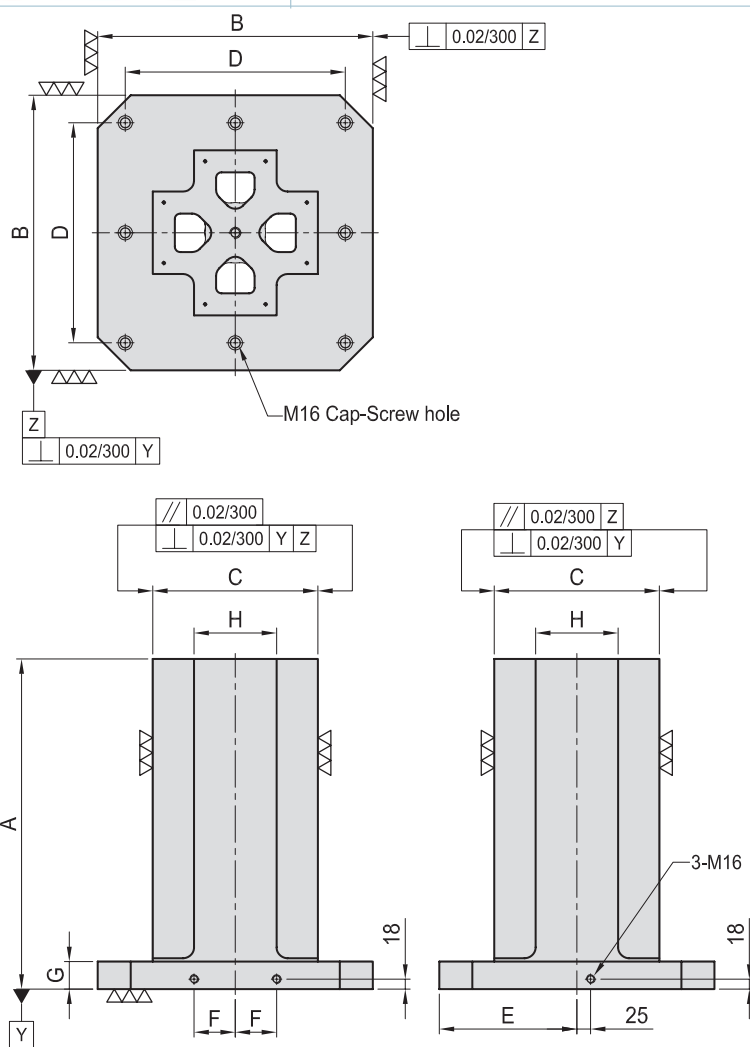

MODEL NO.	A	B	C	D	E	F	G	H	Mounting holes	kg
BP29-400400-0500	500	400	250	320	200	55	50	125	4	154
BP29-400400-0650	650									188
BP29-500500-0600	600	500	300	400	250	75	50	150	8	244
BP29-500500-0750	750									287
BP29-630630-0700	700	630	350	500	315	100	50	200	8	373
BP29-630630-0850	850									424
BP29-800800-0800	800	800	500	640	400	135	50	300	8	648
BP29-800800-1000	1000									753

\*Special Design Welcome !



# BP30

## MC十字基座

### CROSS TOOLING COLUMN

材质: HT250/QT500

热处理: 退火

用处: 适用于卧式和立式MC

优点: 以孔定位方式, 利用标准化治具零件, 可以快速组合成一整套符合需求的治具。

Material: Cast Iron HT250/QT500

Heat treated (Normalized)

Application: HMC/VMC.

Features: Alignment bushing & thread insert at every hole location, easily adapts to standardized jig components.

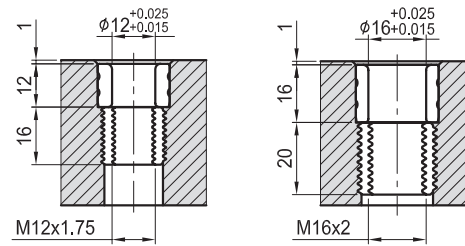
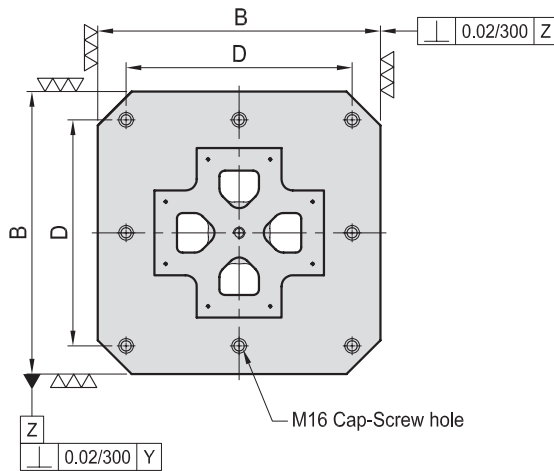
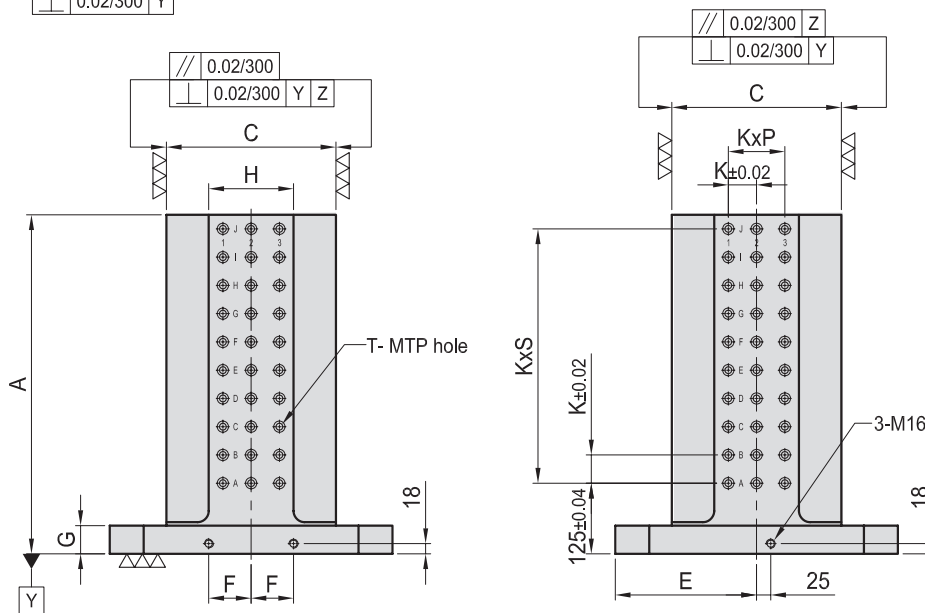

Figure T



MODEL NO.	A	B	C	D	E	F	G	H	K	P	S	T	MTP	Mounting holes	kg	MODEL NO.	A	B	C	D	E	F	G	H	K	P	S	T	MTP	Mounting holes	kg		
BP30-400400-0500-12	500	400	250	320	200	55	50	125	50	1	7	Ø12	M12	64	4	152	BP30-400400-0500-16	500	400	250	320	200	55	50	125	50	1	7	Ø16	M16	64	4	151
BP30-400400-0650-12	650										10			88	4	186	BP30-400400-0650-16	650									10			88	4	184	
BP30-500500-0600-12	600	500	300	400	250	75	50	150	50	2	9	Ø12	M12	120	8	250	BP30-500500-0600-16	600	500	300	400	250	75	50	150	50	2	9	Ø16	M16	120	8	247
BP30-500500-0750-12	750										12			156	8	293	BP30-500500-0750-16	750								12			156	8	290		
BP30-630630-0700-12	700	630	350	500	315	100	50	200	50	3	11	Ø12	M12	192	8	368	BP30-630630-0700-16	700	630	350	500	315	100	50	200	50	3	11	Ø16	M16	192	8	364
BP30-630630-0850-12	850										14			240	418		BP30-630630-0850-16	850								14			240	413			
BP30-800800-0800-12	800	800	500	640	400	135	50	300	50	5	13	Ø12	M12	336	8	640	BP30-800800-0800-16	800	800	500	640	400	135	50	300	50	5	13	Ø16	M16	336	8	633
BP30-800800-1000-12	1000										17			432	740		BP30-800800-1000-16	1000								17			432	733			

\*Special Design Welcome !



## BP31

### MC六面基座 HEXAGONAL CUBE

材质: HT250/QT500  
热处理: 退火  
用处: 适用于卧式和立式MC  
优点: 可以根据实际需求, 自行钻孔加工制作专用治具。

Material: Cast Iron HT250/QT500  
Heat treated (Normalized)  
Application: HMC/VMC.  
Features: Ready to accept a hole pattern for your special jig.

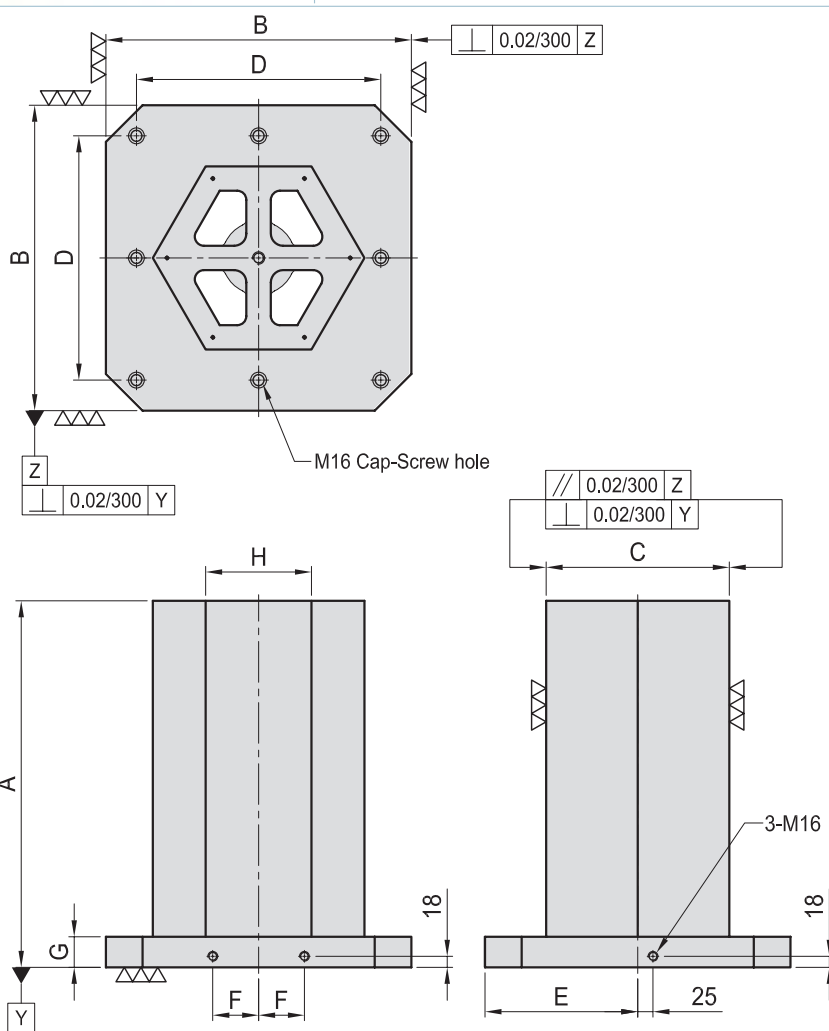

MODEL NO.	A	B	C	D	E	F	G	H	Mounting holes	kg
BP31-400400-0500	500	400	250	320	200	55	50	144	4	151
BP31-400400-0650	650									183
BP31-500500-0600	600	500	300	400	250	75	50	173	8	233
BP31-500500-0750	750									272
BP31-630630-0700	700	630	350	500	315	100	50	202	8	361
BP31-630630-0850	850									408
BP31-800800-0800	800	800	500	640	400	135	50	289	8	619
BP31-800800-1000	1000									713

\*Special Design Welcome !

**BP32**

**MC六面基座 HEXAGONAL CUBE**



材质: HT250/QT500  
 热处理: 退火  
 用处: 适用于卧式和立式MC  
 优点: 以孔定位方式, 利用标准化治具零件, 可以快速组合成一套符合需求的治具。

Material: Cast Iron HT250/QT500  
 Heat treated (Normalized)  
 Application: HMC/VMC.  
 Features: Alignment bushing & thread insert at every hole location, easily adapts to standardized Jtg components.

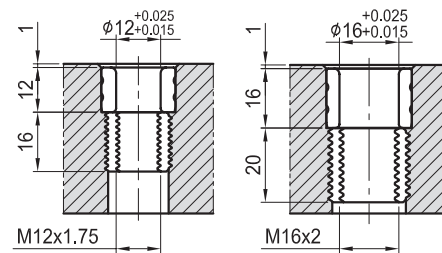
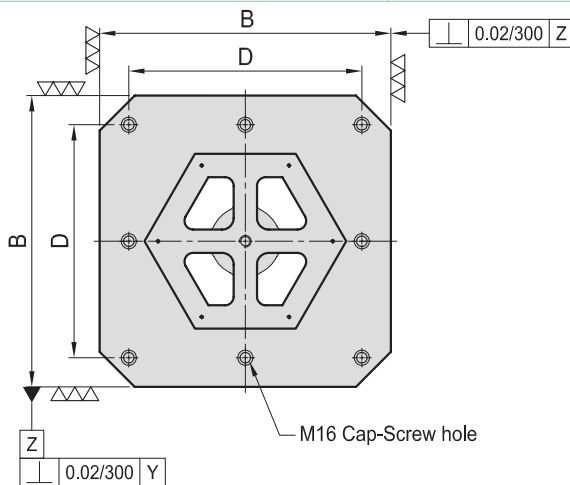
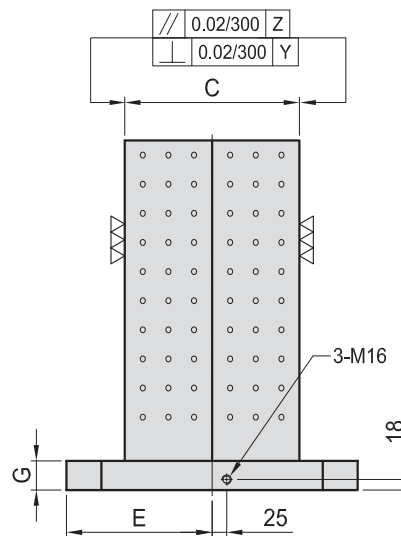
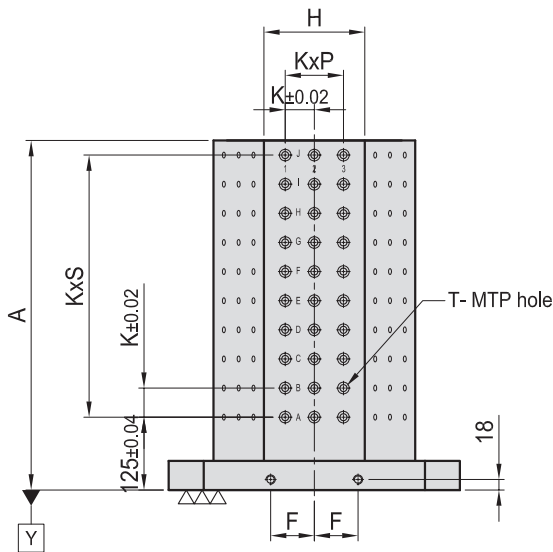

Figure T



MODEL NO.	A	B	C	D	E	F	G	H	K	P	S	T	MTP	Mounting holes	kg	MODEL NO.	A	B	C	D	E	F	G	H	K	P	S	T	MTP	Mounting holes	kg
BP32-400400-0500-12	500	400	250	320	200	55	50	144	50	1	7	Ø12	M12	96	149	BP32-400400-0500-16	500	400	250	320	200	55	50	144	50	1	7	Ø16	M16	96	147
BP32-400400-0650-12	650										10			132	180	BP32-400400-0650-16	650									10			132	177	
BP32-500500-0600-12	600	500	300	400	250	75	50	173	50	2	9	Ø12	M12	180	228	BP32-500500-0600-16	600	500	300	400	250	75	50	173	50	2	9	Ø16	M16	180	224
BP32-500500-0750-12	750										12			234	267	BP32-500500-0750-16	750									12			234	262	
BP32-630630-0700-12	700	630	350	500	315	100	50	202	50	2	11	Ø12	M12	216	356	BP32-630630-0700-16	700	630	350	500	315	100	50	202	50	2	11	Ø16	M16	216	351
BP32-630630-0850-12	850										14			270	407	BP32-630630-0850-16	850									14			270	396	
BP32-800800-0800-12	800	800	500	640	400	135	50	289	50	4	13	Ø12	M12	420	609	BP32-800800-0800-16	800	800	500	640	400	135	50	289	50	4	13	Ø16	M16	420	600
BP32-800800-1000-12	1000										17			540	700	BP32-800800-1000-16	1000									17			540	688	

\*Special Design Welcome !



# BP33

## MC八面基座 OCTAGONAL CUBE

材质: HT250/QT500  
 热处理: 退火  
 用处: 适用于卧式和立式MC  
 优点: 可以根据实际需求, 自行钻孔加工制作专用治具。

Material: Cast Iron HT250/QT500  
 Heat treated (Normalized)  
 Application: HMC/VMC.  
 Features: Ready to accept a hole pattern for your special jig.

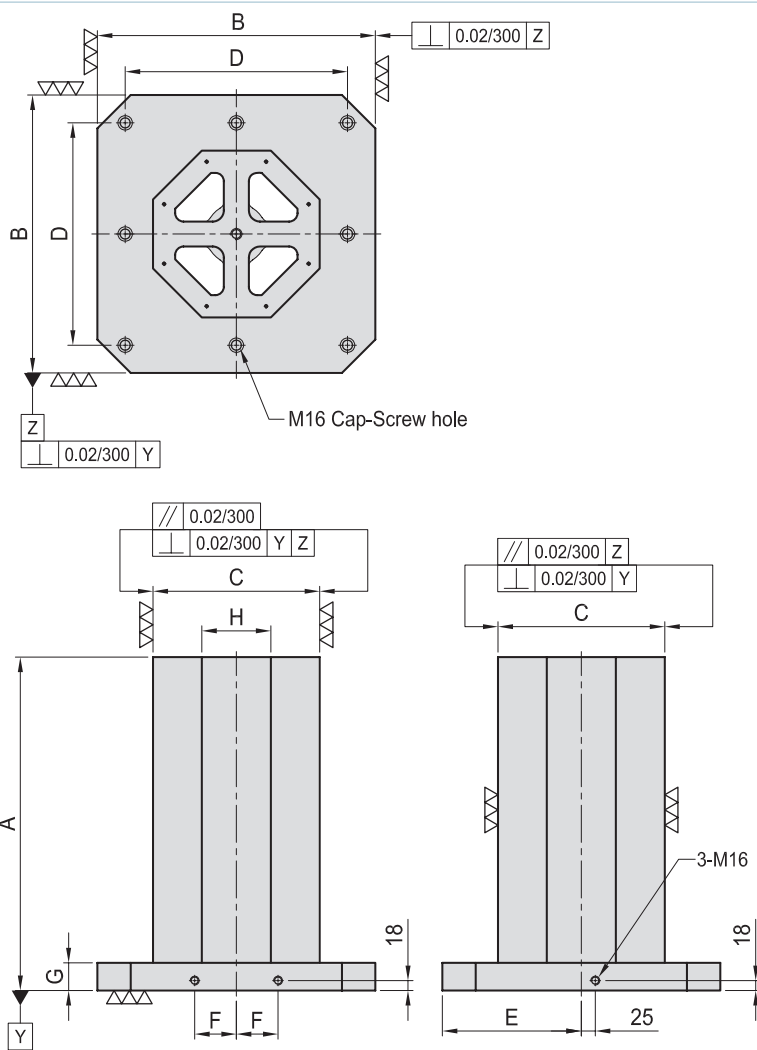

MODEL NO.	A	B	C	D	E	F	G	H	Mounting holes	kg
BP33-400400-0500	500	400	250	320	200	55	50	103	4	148
BP33-400400-0650	650									179
BP33-500500-0600	600	500	300	400	250	75	50	124	8	227
BP33-500500-0750	750									264
BP33-630630-0700	700	630	350	500	315	100	50	145	8	350
BP33-630630-0850	850									395
BP33-800800-0800	800	800	500	640	400	135	50	207	8	622
BP33-800800-1000	1000									711

\*Special Design Welcome !





# BP34

## MC八面基座 OCTAGONAL CUBE

材质: HT250/QT500

热处理: 退火

用处: 适用于卧式和立式MC

优点: 以孔定位方式, 利用标准化治具零件, 可以快速组合成

一套符合需求的治具。

Material: Cast Iron HT250/QT500

Heat treated(Normalized)

Application: HMC/VMC.

Features: Alignment bushing & thread insert at every hole location, easily adapts to standardized jig components.

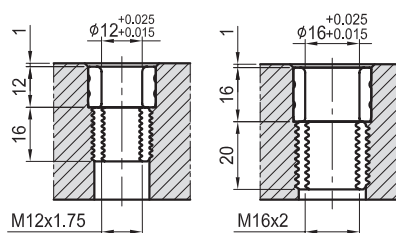
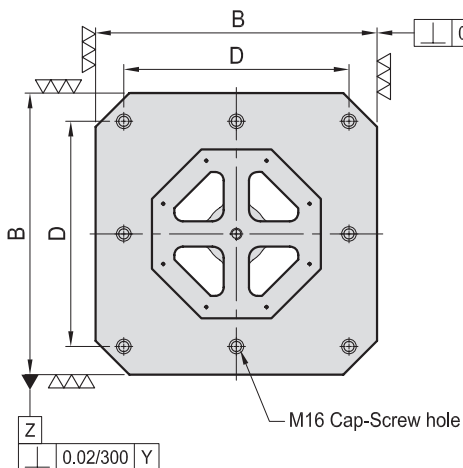
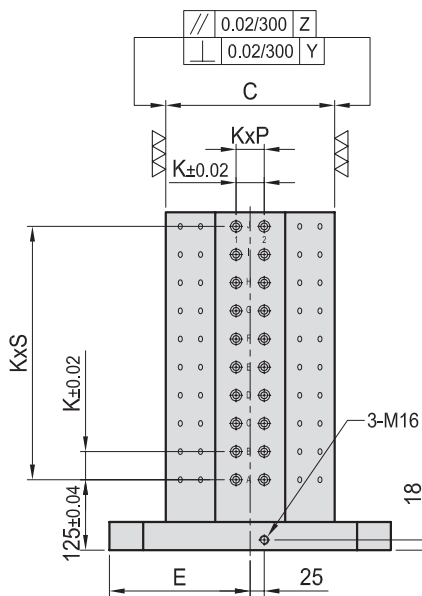
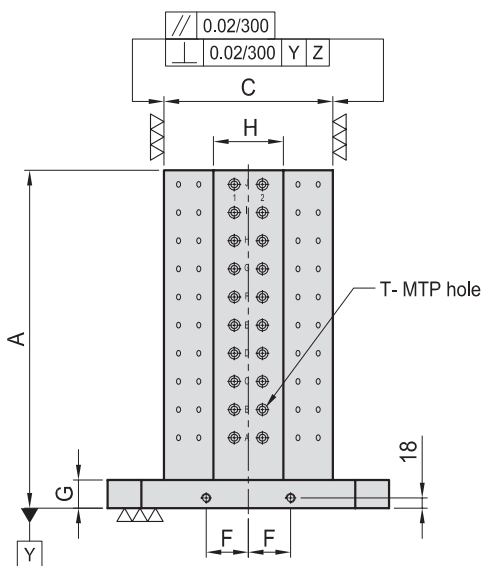

Figure T



MODEL NO.	A	B	C	D	E	F	G	H	K	P	S	T	MTP	Mounting holes	kg	MODEL NO.	A	B	C	D	E	F	G	H	K	P	S	T	MTP	Mounting holes	kg
BP34-400400-0500-12	500	400	250	320	200	55	50	103	50	1	7	Ø12	M12	128	145	BP34-400400-0500-16	500	400	250	320	200	55	50	103	50	1	7	Ø16	M16	128	142
BP34-400400-0650-12	650										10			176	175	BP34-400400-0650-16	650										10		176	171	
BP34-500500-0600-12	600	500	300	400	250	75	50	124	50	1	9	Ø12	M12	160	223	BP34-500500-0600-16	600	500	300	400	250	75	50	124	50	1	9	Ø16	M16	160	219
BP34-500500-0750-12	750										12			208	259	BP34-500500-0750-16	750									12		208	255		
BP34-630630-0700-12	700	630	350	500	315	100	50	145	50	1	11	Ø12	M12	192	345	BP34-630630-0700-16	700	630	350	500	315	100	50	145	50	1	11	Ø16	M16	192	341
BP34-630630-0850-12	850										14			240	389	BP34-630630-0850-16	850									14		240	384		
BP34-800800-0800-12	800	800	500	640	400	135	50	207	50	3	13	Ø12	M12	448	611	BP34-800800-0800-16	800	800	500	640	400	135	50	207	50	3	13	Ø16	M16	448	601
BP34-800800-1000-12	1000										17			576	697	BP34-800800-1000-16	1000									17		576	685		

\*Special Design Welcome !



**BP35**

**H型垫块 H/CAST SECTION**

材质: HT250/QT500  
热处理: 退火  
优点: 因为工件的高低不同给予辅助用。

Material: Cast Iron HT250/QT500  
Heat treated(Normalized)  
Features: Easily adapts to standardized jig components

MODEL NO.	A	B	C	M	N	kg
BP35-085085-0100-12	85	100	85	M12	M12	3.64
BP35-085085-0125-12		125				
BP35-085085-0100-16	85	100	85	M16	M16	4.13
BP35-085085-0125-16		125				

\*Special Design Welcome !

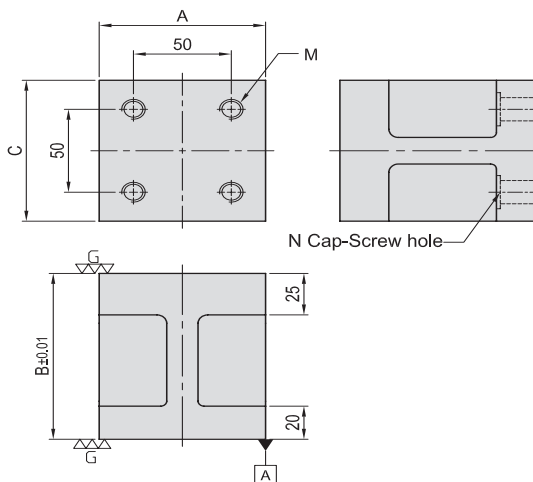

**BP36**

**H型垫块 H/CAST SECTION**

材质: HT250/QT500  
热处理: 退火  
优点: 因为工件的高低不同给予辅助用。

Material: Cast Iron HT250/QT500  
Heat treated(Normalized)  
Features: Easily adapts to standardized jig components

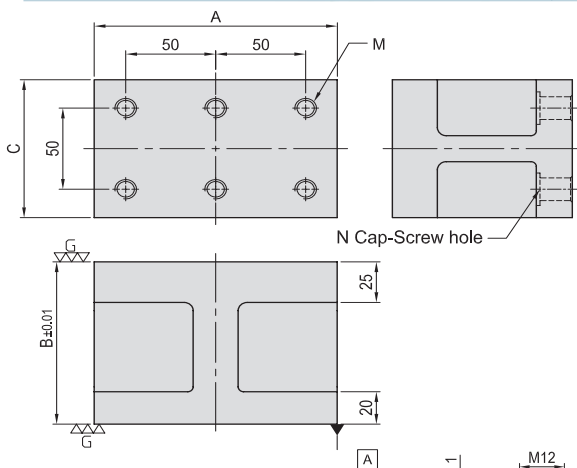

MODEL NO.	A	B	C	M	N	kg
BP36-135085-0100-12	135	100	85	M12	M12	5.76
BP36-135085-0125-12		125				
BP36-135085-0100-16	135	100	85	M16	M16	6.53
BP36-135085-0125-16		125				

\*Special Design Welcome !

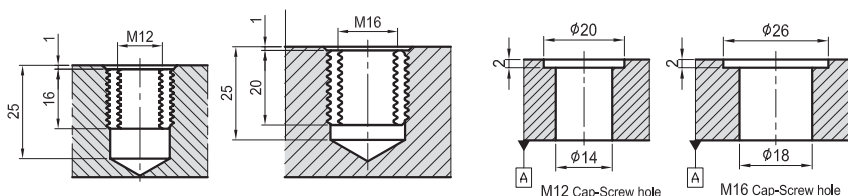
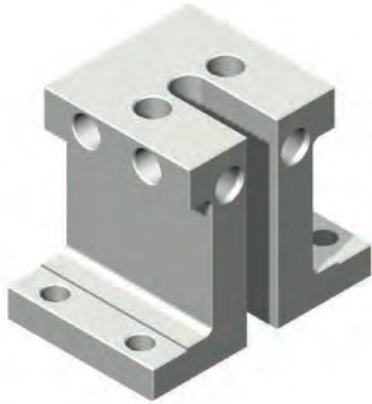

Figure M

Figure N

**BP37**

**H型垫块 H/CAST SECTION**



材质: HT250/QT500  
 热处理: 退火  
 优点: 因为工件的高低不同给予辅助用。

Material: Cast Iron HT250/QT500  
 Heat treated(Normalized)  
 Features: Easily adapts to standardized jig components

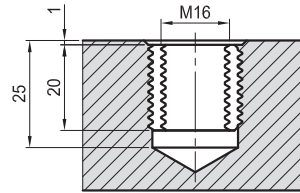
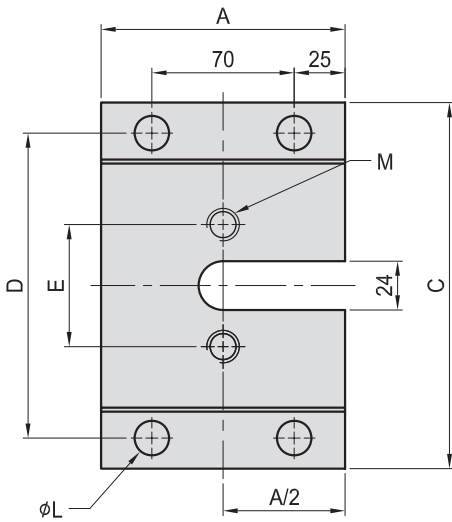
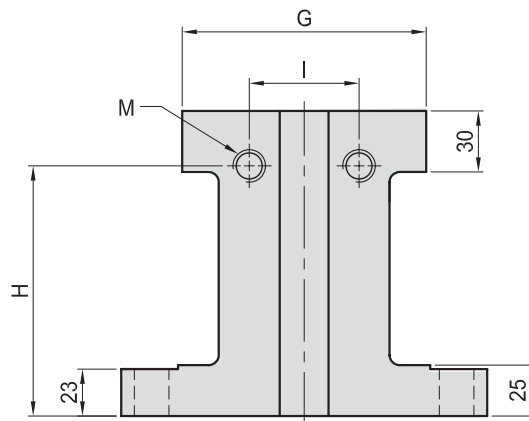
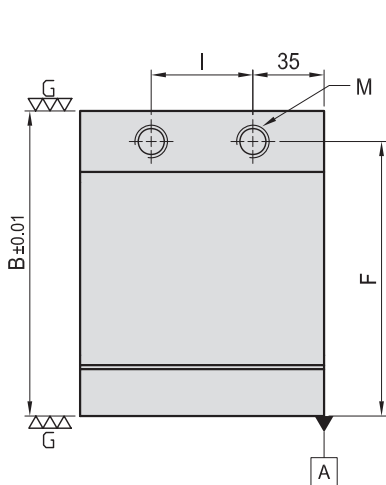

Figure M



MODEL NO.	A	B	C	D	E	F	G	H	I	M	L	kg
BP37-120180-0150-16	120	150	180	150	60	135	120	123	50	M16	17	15.5

\*Special Design Welcome !

## 可以按需定制的产品

Products that can be customized according to needs

