

BT30/BT40/BBT40 高精度液压刀柄 BT30/BT40/BBT40 High precision hydraulic mill chuck

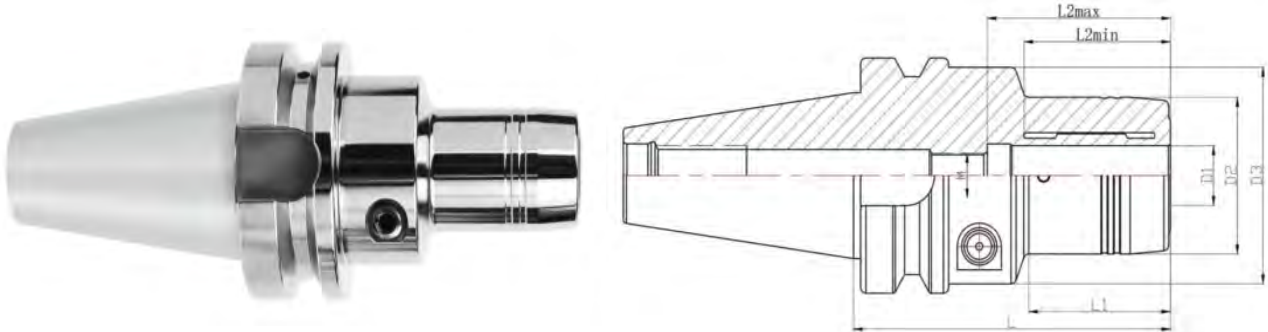

型号 Cat. No	D1	D2	D3	L	L1	L2min	L2max	M
BT30-HDC03-60L	3	21	45	60	29	23	84	-
BT30-HDC04-60L	4	21	45	60	29	23	84	-
BT30-HDC06-75L	6	30	46	75	24	28	50	M5-
BT30-HDC08-75L	8	32	46	75	24	28	50	M6-
BT30-HDC10-75L	10	34	46	75	24	34	50	M8-
BT30-HDC12-75L	12	36	46	75	25	36	50	M8-
BT30-HDC14-90L	14	38	46	90	40	41	52	M8-
BT30-HDC16-90L	16	40	46	90	33	41	52	M8-
BT30-HDC18-90L	18	42	46	90	41	41	52	M8-
BT30-HDC20-90L	20	46	46	90	--	41	52	M8-
BT40-HDC04-90L	4	28	46	90	38	24	42	-
BT40-HDC06-90L	6	30	46	90	38	28	44	M5-
BT40-HDC08-90L	8	32	48	90	38	28	44	M6-
BT40-HDC10-90L	10	36	52	90	40	37	51	M8-
BT40-HDC12-90L	12	38	54	90	40	37	51	M8-
BT40-HDC14-90L	14	40	56	90	40	41	52	M12-
BT40-HDC16-90L	16	42	58	90	40	41	52	M12-
BT40-HDC18-90L	18	43	59	90	40	41	52	M12-
BT40-HDC20-90L	20	46	60	90	40	41	53	M12-
BT40-HDC25-90L	25	52	62	105	55	49	65	M12-
BT40-HDC25-90L	32	63	--	105	--	52	65	M12-
BBT40-HDC04-90L	4	28	46	90	38	24	42	-
BBT40-HDC06-90L	6	30	46	90	38	28	44	M5-
BBT40-HDC08-90L	8	32	48	90	38	28	44	M6-
BBT40-HDC10-90L	10	36	52	90	40	37	51	M8-
BBT40-HDC12-90L	12	38	54	90	40	37	51	M8-
BBT40-HDC14-90L	14	40	56	90	40	41	52	M12-
BBT40-HDC16-90L	16	42	58	90	40	41	52	M12-
BBT40-HDC18-90L	18	43	59	90	40	41	52	M12-
BBT40-HDC20-90L	20	46	60	90	40	41	53	M12-
BBT40-HDC25-90L	25	52	62	105	55	49	65	M12-
BBT40-HDC25-90L	32	63	--	105	--	52	65	M12-

BT40 细长型高精度液压刀柄 BT40 Slender High precision hydraulic mill chuck

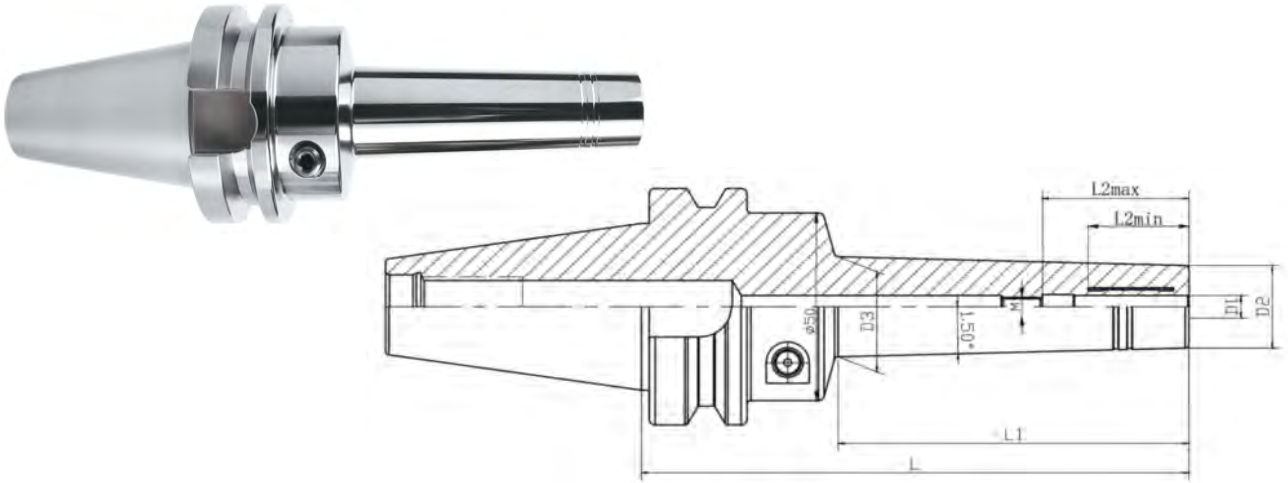

型号 Cat. No	D1	D2	D3	L	L1	L2min	L2max	M
BT40-HDC06-140S	6	22	26.5	140	90	25	37	M5-
BT40-HDC08-140S	8	24	28.7	140	90	25	37	M6-
BT40-HDC10-140S	10	25	29.7	140	90	31	42.5	M8-
BT40-HDC12-140S	12	28	32.7	140	90.5	34	47.5	M8-
BT40-HDC20-140S	20	40	44.7	140	91	39	53	M12

数控磨刀机专用夹具 CNC Grinding tool fixture



Use model

Anka: FX5 (with hydraulic cylinder) FX7 FG (with air cylinder) GX7 MX7 MX5 TX7+

Walter: POWER series BASIC MINI POWER ESSENTIAL

Support most domestic five-axis tool sharpening fixtures

Features: Spacer design to avoid wear on the collet, extend the life of the collet, enhance the clamping force, and can be used to clamp bars with larger diameters without disassembling the claws

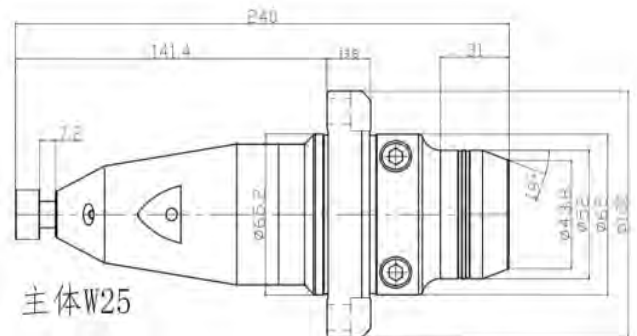
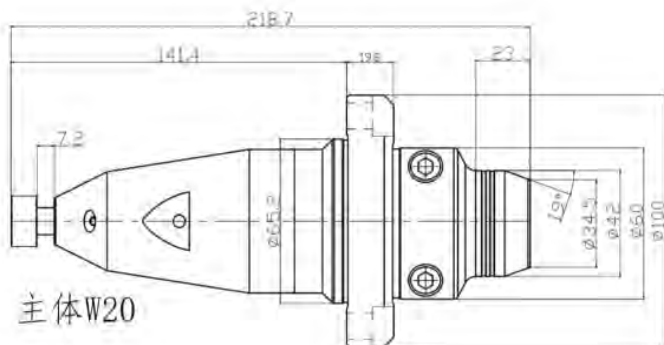

BT50/BBT50 高精度液压刀柄 BT50/BBT50 High precision hydraulic mill chuck

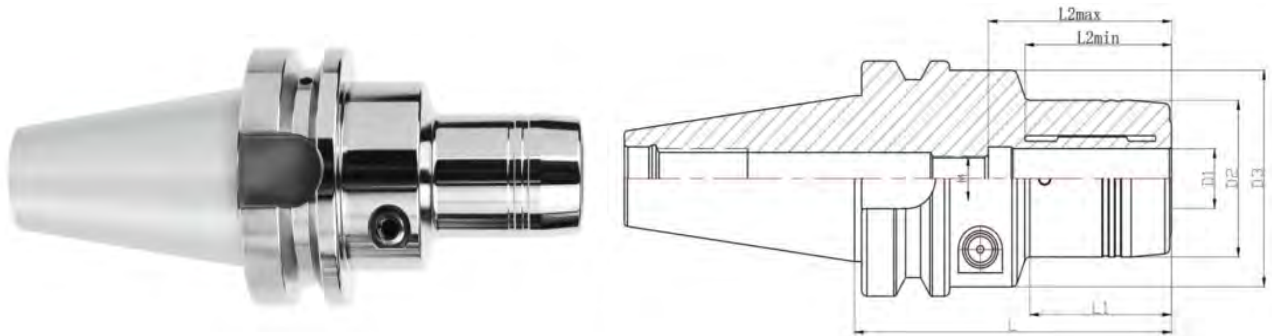

型号 Cat. No	D1	D2	D3	L	L1	L2min	L2max	M
BT50-HDC06-105L	6	30	46	105	38	28	44	M5-
BT50-HDC08-105L	8	32	48	105	38	28	44	M6-
BT50-HDC10-105L	10	36	52	105	40	37	51	M8-
BT50-HDC12-105L	12	38	54	105	40	37	51	M8-
BT50-HDC14-105L	14	40	56	105	40	41	52	M12-
BT50-HDC16-105L	16	42	58	105	40	41	52	M12-
BT50-HDC18-105L	18	43	59	105	39	40	51	M12-
BT50-HDC20-105L	20	46	60	105	40	41	53	M12-
BT50-HDC25-120L	25	52	62	120	55	49	65	M12-
BT50-HDC32-120L	32	63	72	120	56	52	65	M12-
BBT type								
BBT50-HDC06-105L	6	30	46	105	38	28	44	M5-
BBT50-HDC08-105L	8	32	48	105	38	28	44	M6-
BBT50-HDC10-105L	10	36	52	105	40	37	51	M8-
BBT50-HDC12-105L	12	38	54	105	40	37	51	M8-
BBT50-HDC14-105L	14	40	56	105	40	41	52	M12-
BBT50-HDC16-105L	16	42	58	105	40	41	52	M12-
BBT50-HDC18-105L	18	43	59	105	39	40	51	M12-
BBT50-HDC20-105L	20	46	60	105	40	41	53	M12-
BBT50-HDC25-120L	25	52	62	120	55	49	65	M12-
BBT50-HDC32-120L	32	63	72	120	56	52	65	M12-
Extended type								
BT50-HDC06-150L	6	30	46	150	38	28	44	M5-
BT50-HDC08-150L	8	32	48	150	38	28	44	M6-
BT50-HDC10-150L	10	36	52	150	40	37	51	M8-
BT50-HDC12-150L	12	38	54	150	40	37	51	M8-
BT50-HDC14-150L	14	40	56	150	40	41	52	M12-
BT50-HDC16-150L	16	42	58	150	40	41	52	M12-
BT50-HDC18-150L	18	43	59	150	39	40	51	M12-
BT50-HDC20-150L	20	46	60	150	40	41	53	M12-
BT50-HDC25-150L	25	52	62	150	55	49	65	M12-
BT50-HDC32-150L	32	63	72	150	56	52	65	M12-

HSK40E/HSK50E 高精度液压刀柄

HSK40E/HSK50E High precision hydraulic mill chuck

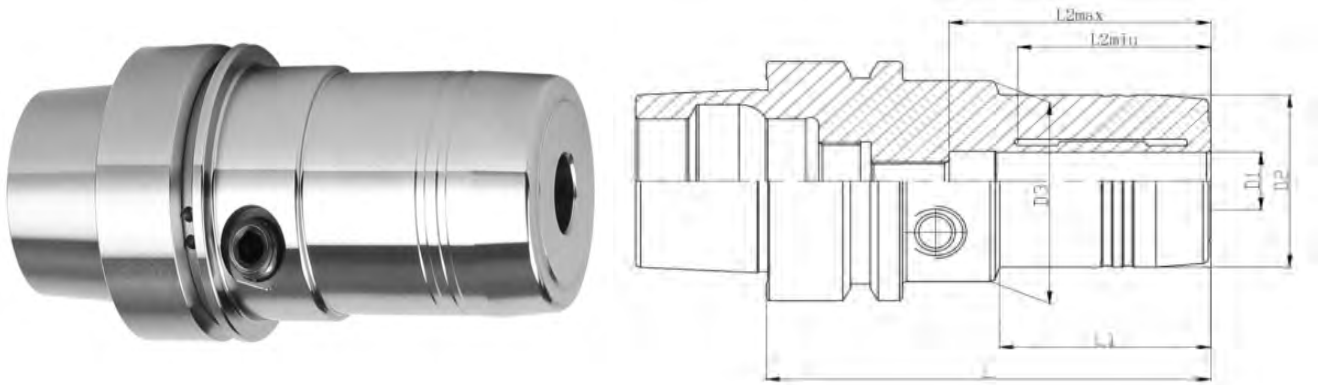

型号 Cat. No	D1	D2	D3	L	L1	L2min	L2max	M
HSK40E-HDC06-70L	6	30	42	70	25.5	26	38	M5-
HSK40E-HDC08-70L	8	32	42	70	26	28	38	M6-
HSK40E-HDC10-75L	10	34	42	75	32.6	34	45	M8-
HSK40E-HDC12-80L	12	36	42	80	40	36	50	M8-
HSK50E-HDC06-70L	6	30	42	70	25.5	26	38	M5-
HSK50E-HDC08-70L	8	32	42	70	26	28	38	M6-
HSK50E-HDC10-80L	10	34	42	80	32.6	34	45	M8-
HSK50E-HDC12-85L	12	36	42	85	40	36	50	M8-
HSK50E-HDC16-90L	16	40	42	90	43	41	52	M8-
HSK50E-HDC20-90L	20	42	42	90	64	41	52	M8-

HSK50A 高精度液压刀柄

HSK50A High precision hydraulic mill chuck

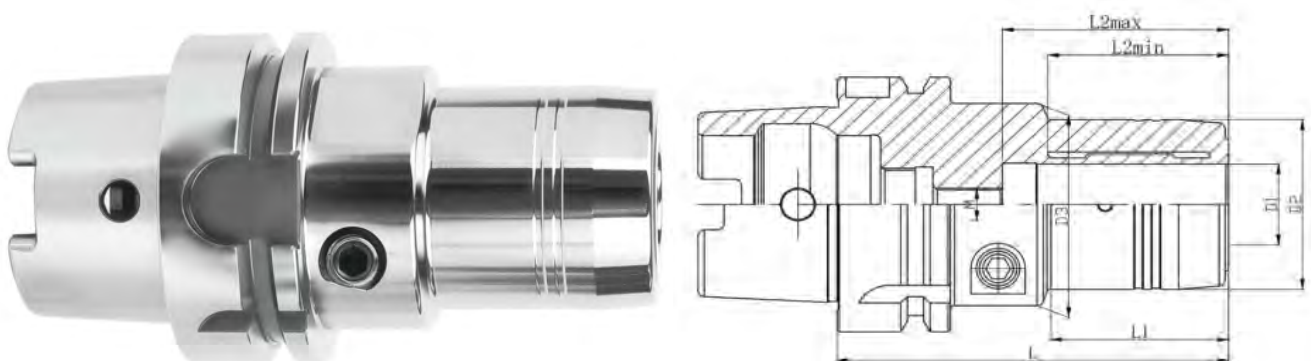

型号Cat No	D1	D2	D3	L	L1	L2min	L2max	M
HSK50A-HDC06-70L	6	30	42	70	25.5	26	38	M5-
HSK50A-HDC08-70L	8	32	42	70	26	28	38	M6-
HSK50A-HDC10-80L	10	34	42	80	32.6	34	45	M8-
HSK50A-HDC12-85L	12	36	42	85	40	36	50	M8-
HSK50A-HDC16-90L	16	40	42	90	43	41	52	M8-
HSK50A-HDC20-90L	20	42	42	90	64	41	52	M8-

HSK63A 高精度液压刀柄

HSK63A High precision hydraulic mill chuck

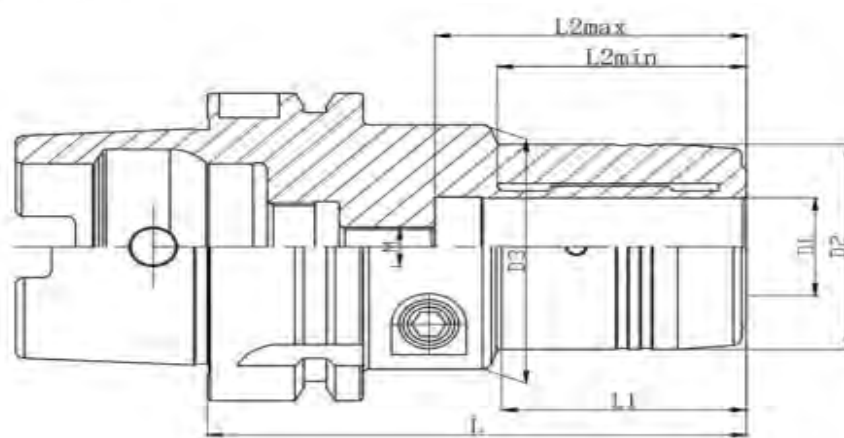

型号 Cat. No	D1	D2	D3	L	L1	L2min	L2max	M
HSK63A-HDC06-80L	6	32	48	80	32	29	46	M5-
HSK63A-HDC06-125L	6	32	48	125	38.5	28	44.5	M5-
HSK63A-HDC8-80L	8	34	50	80	32	29	46	M6-
HSK63A-HDC8-125L	8	32	48	125	38.5	28	44.5	M6-
HSK63A-HDC10-80L	10	36	50	80	32	31	50	M8-
HSK63A-HDC10-125L	10	36	50	125	40	37	51	M8-
HSK63A-HDC12-80L	12	38	50	80	32	32	50	M8-
HSK63A-HDC12-125L	12	38	50	125	41	37	51	M8-
HSK63A-HDC14-80L	14	40	50	80	40	38	50	M8-
HSK63A-HDC16-90L	16	42	50	90	41	40	51	M8-
HSK63A-HDC16-125L	16	42	50	125	43	40	52	M8-
HSK63A-HDC18-90L	18	42	50	90	41	40	51	M8-
HSK63A-HDC20-90L	20	42	50	90	41	40	52.5	M8-
HSK63A-HDC20-120L	20	44	50	125	41	40	52.5	M8-
HSK63A-HDC20-175L	20	42	50	175	41	40	52.5	M8-
HSK63A-HDC20-200L	20	42	50	200	45	40	52.5	M8-
HSK63A-HDC25-1100L	25	53	63	110	55.5	45	61	M8-
HSK63A-HDC32-110L	32	63	63	110	--	55	65	M8-

HSK100A 高精度液压刀柄

HSK100A High precision hydraulic mill chuck

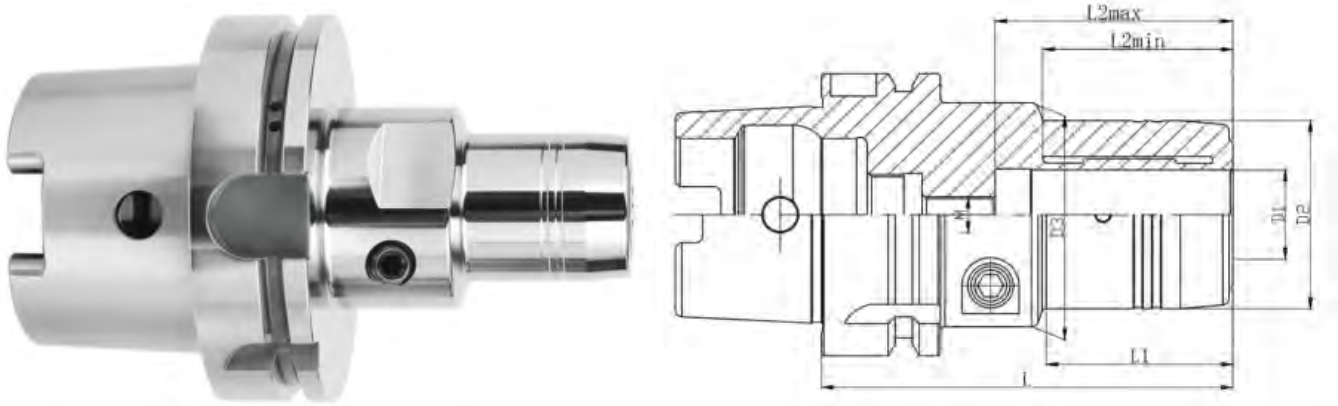

型号 Cat. No	D1	D2	D3	L	L1	L2min	L2max	M
HSK100A-HDC06-90L	6	30	48	90	31	28	44.5	M5-
HSK100A-HDC08-90L	8	32	48	90	31	28	44.5	M6-
HSK100A-HDC10-105L	10	36	50	105	38	37	51	M8-
HSK100A-HDC12-105L	12	38	52	105	40	37	51	M8-
HSK100A-HDC14-105L	14	38	52	105	41	41	51	M8-
HSK100A-HDC16-105L	16	41	54	105	42	41	52	M12-
HSK100A-HDC18-105L	18	42	50	105	41	41	52	M12-
HSK100A-HDC20-105L	20	43	54	105	41	41	53	M12-
HSK100A-HDC25-110L	25	52	62	110	55	49	65	M12-
HSK100A-HDC32-110L	32	63	72	110	57	52	65	M12-

SK50 高精度液压刀柄

SK50 High precision hydraulic mill chuck

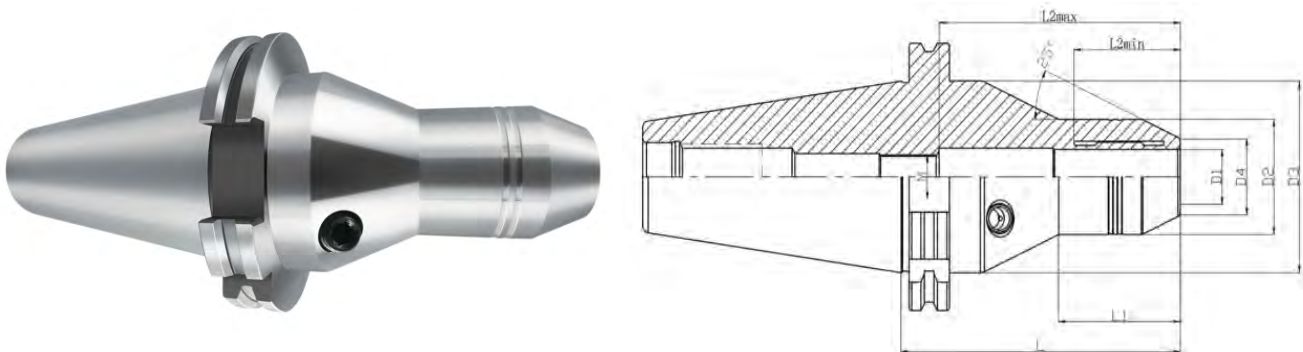

型号Cat No	D1	D2	D3	D4	L	L1	L2min	L2max	M
SK50-HDC12M-110L	12	36.5	60	21.5	110	55	34	50	M8
SK50-HDC14M-110L	14	38	60	23.5	110	60	34	50	M8
SK50-HDC16M-110L	16	39.5	60	25.5	110	60	38	53	M8
SK50-HDC18M-110L	18	41	60	27.5	110	60	38	53	M16
SK50-HDC20M-110L	20	42	70	28	110	47	41	95	M16

SK50 高精度液压刀柄 SK50 High precision hydraulic mill chuck

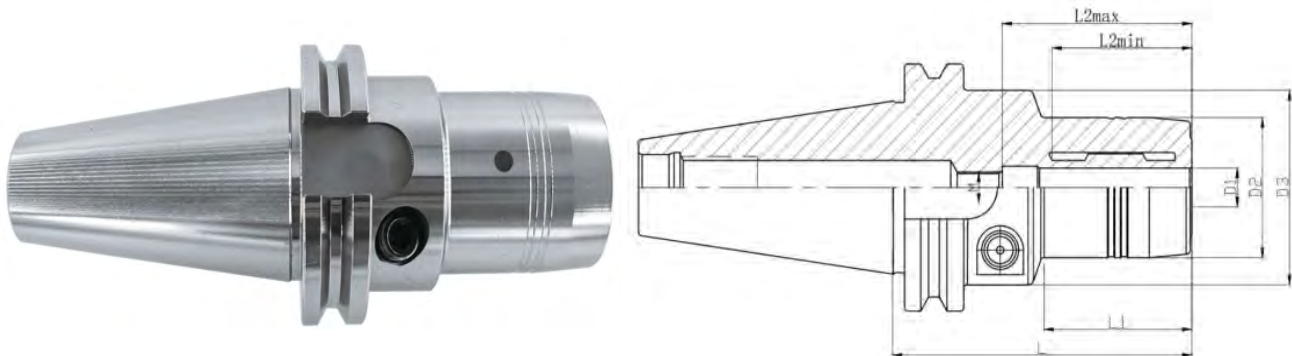

型号 Cat. No	D1	D2	D3	L	L1	L2min	L2max	M
SK50-HDC06-90L	6	30	50	90	38.5	28	44	M5-
SK50-HDC08-90L	8	32	50	90	38.5	28	44	M6-
SK50-HDC10-90L	10	36	50	90	40.5	37	51	M8-
SK50-HDC12-90L	12	38	50	90	40.5	37	51	M8-
SK50-HDC14-90L	14	40	50	90	40.5	41	52	M12-
SK50-HDC16-90L	16	42	50	90	40.5	41	52	M12-
SK50-HDC20-90L	20	4	50	90	40.8	41	53	M12-
SK50-HDC25-110L	25	52	57	110	60	49	65	M8-
SK50-HDC32-110L	32	63	63	110	91	52	65	M8-

SK40 高精度液压刀柄 SK40 High precision hydraulic mill chuck

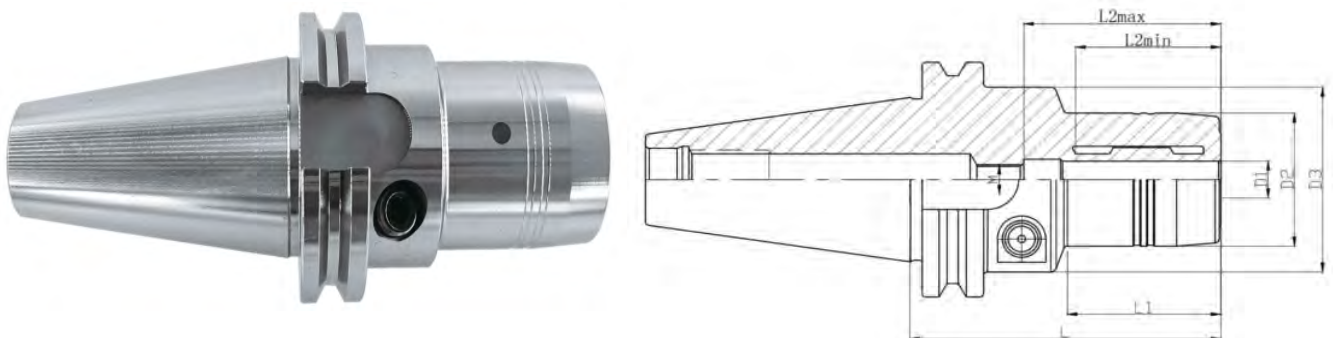

型号 Cat. No	D1	D2	D3	L	L1	L2min	L2max	M
SK40-HDC06-80.5L	6	30	50	80.5	38	28	44	M5-
SK40-HDC08-80.5L	8	32	50	80.5	38	28	44	M6-
SK40-HDC10-80.5L	10	36	50	80.5	40	37	51	M8-
SK40-HDC12-80.5L	12	38	50	80.5	40	37	51	M8-
SK40-HDC16-80.5L	16	42	50	80.5	41	41	52	M12-
SK40-HDC20-80.5L	20	42	50	80.5	41	41	53	M12-